

**COUNTY OF UNION  
BUILDING DEPARTMENT  
322 East Main Street  
Union, S.C. 29379  
Phone (864) 424-2341 Fax (864) 427-7851**

**MOBILE HOME PERMITTING & INSTALLATION GUIDE  
\*\*\*ATTENTION\*\*\***

PLEASE DO NOT CALL FOR POWER INSPECTION UNTIL  
ALL THE FOLLOWING ITEMS ARE COMPLETED:

- Landing at each entrance and every door where the door swings out over the top step
- Steps at every entranceway
- Handrails and pickets (if landing is 30" above ground)
- Tiedowns completed
- Street numbers are on dwelling and at street (if required)
- Driveway pipe is installed (Union County Road Dept. 429-1675)
- If gas appliances, gas test must be completed (10 PSI)
- All electrical wiring must be correctly completed
- All plumbing is connected to sewer system or tank

## **GENERAL INFORMATION**

After the permit has been issued, these steps should be followed to insure the fastest possible service from the Inspection Department and for electrical service to be connected by the Power Company:

1. Call or visit the Power Company serving your area and make an application for power.
2. After the mobile home is completely setup (as stated on the previous page) call the Building Department to request your inspection at 864-429-1616.
3. Have the yellow inspection card posted on or near the mobile home so the inspector can see it from the road, so they can sign the card when approved.
4. Make sure the county decal sticker with the large #44 in the center is placed in the window so it can be viewed as you approach the mobile home.
5. State law requires that the method of sewage disposal be approved by the Health Department before a permit can be issued.
6. If septic system is existing, you must uncover the inlet side of the septic tank (where the pip goes into the tank).

# Mobile Home Electrical Supply

The mobile home service equipment shall be located adjacent to the mobile home and not more than 30 feet from the home. The equipment shall not be mounted on the mobile home. (Unless it comes from the factory allowing mounting on home.)

**(A PERMANENTLY INSTALLED FEEDER CIRCUIT SHALL BE INSTALLED IN ACCORDANCE WITH THE INSTRUCTIONS USING THE DIAGRAMS ATTACHED)**

The meter box and service equipment shall be mounted on a treated pole or other permanent type frame near the home. The service equipment is provided for safety so that the electricity can be turned off from outside the mobile home.

A rain tight connector is used to connect the cable to the meter box. The main service equipment closure shall be bonded to the neutral busbar. Grounding of the main service equipment shall be made by means of a #6 copper wire to an approved ground rod of 8 feet in length driven in the ground near the service pole.

The power feeder from the main service equipment to the inside panel shall consist of four insulated, color coded conductors. The black and red conductors shall be connected to the hot terminals on the load side of the main service equipment breaker and to the line side of the main breaker in the panel box inside the mobile home.

---

Both the white and the green wires are connected to the grounded neutral busbar in the main service equipment located in the outside panel.

In the panel box inside the mobile home, the white wire is connected to the insulated neutral busbar and the green wire is connected to the separate equipment grounding busbar that is bonded to the panel box enclosure.

## FOUR WIRE SYSTEM

USE 4 SEPARATE INSULATED CONDUCTORS APPROVED FOR AMPACITY OF DISCONNECT.

# Overhead Service

Minimum Pole Height 12'

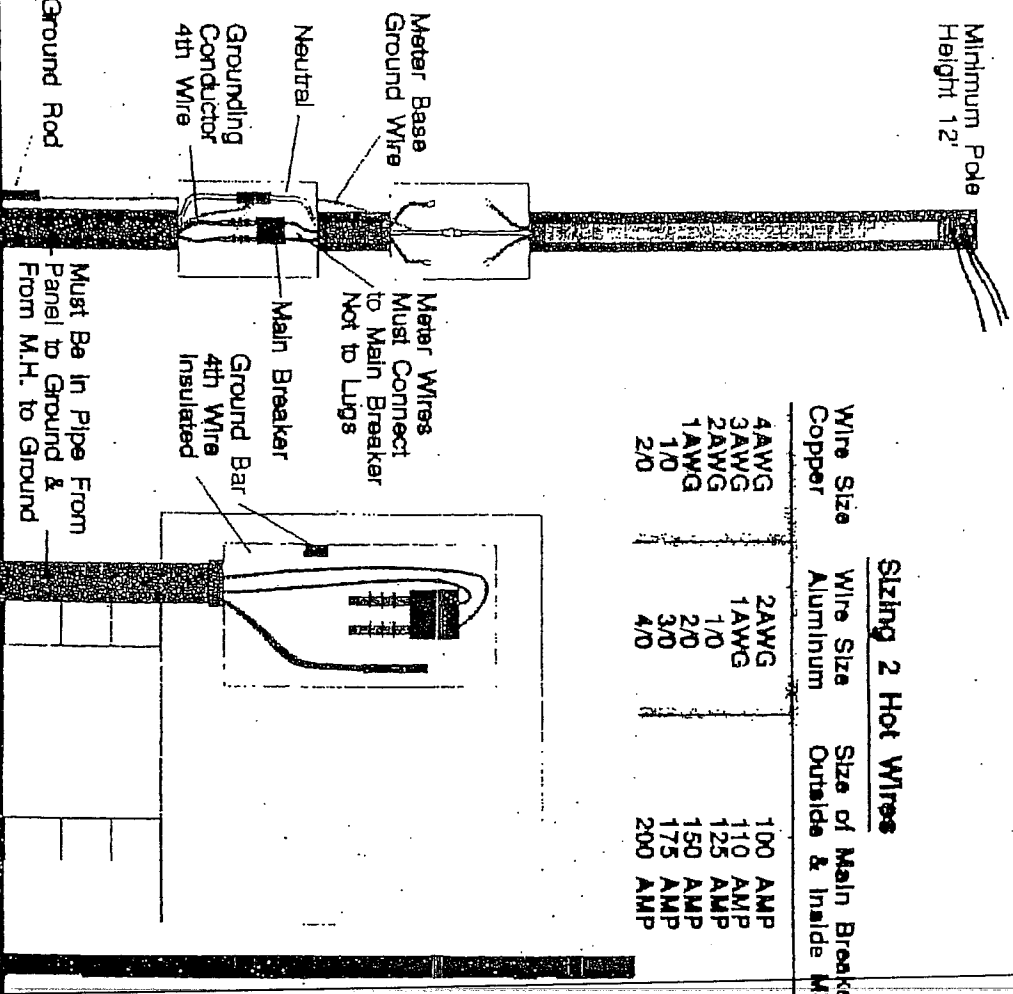

## Sizing 2 Hot Wires

Wire Size Copper	Wire Size Aluminum	Size of Main Breaker Outside & Inside MH
4AWG	2AWG	100 AMP
3AWG	1AWG	110 AMP
2AWG	1/0	125 AMP
1AWG	2/0	150 AMP
1/0	3/0	175 AMP
2/0	4/0	200 AMP

# Underground Service

## Sizing 4th Wire Ground Conductor

Main Size - Copper	Aluminum
40 AMP	#10
60 AMP	#10
100 AMP	#8
200 AMP	#6

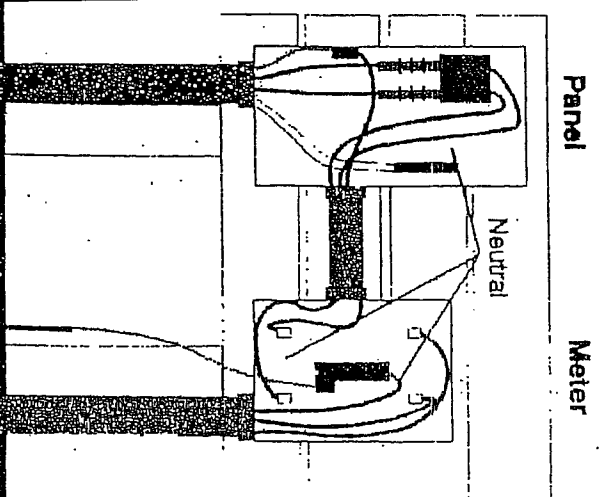

← 24" →

**Pier Construction (for Used Mobile Homes)  
New Mobile Homes use Manufacturer's  
Instructions (leave book on site)**

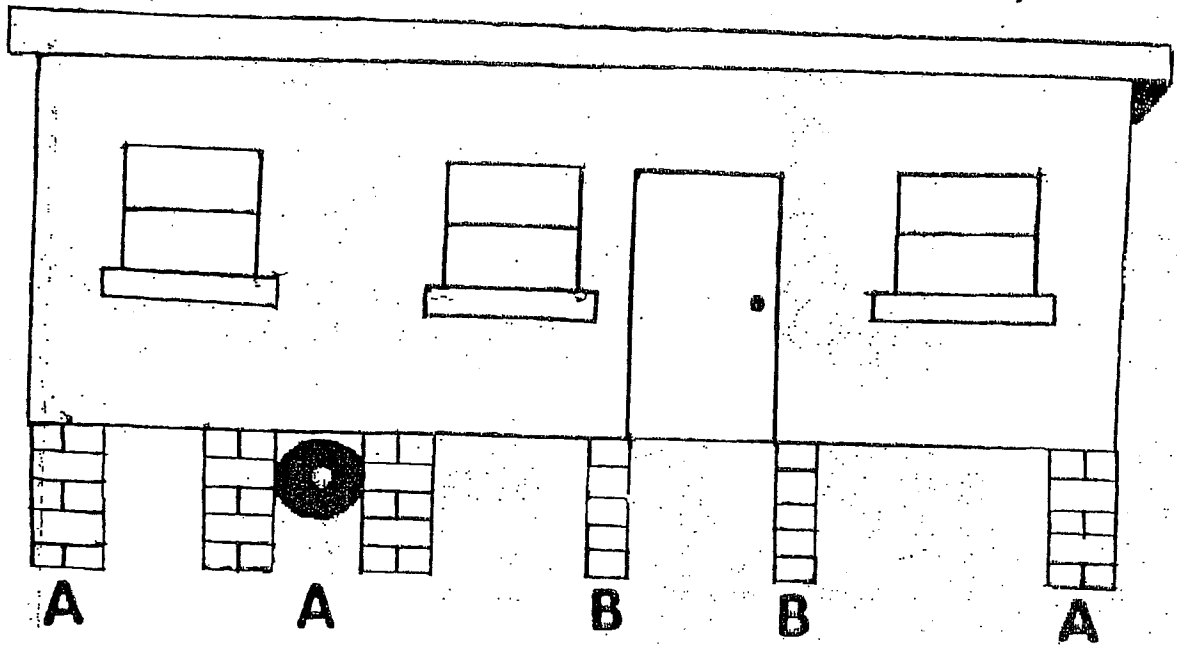

**Type "A" Piers**

1. All "A" piers shall be 16"x16" blocks or two(2) 8"x16" blocks with cells placed in a vertical position.
2. All "A" piers shall be placed on solid concrete blocks on poured footings.
3. One (1) "A" pier shall be placed on each side of each end unit.
4. One (1) "A" pier shall be placed on each side directly in front and behind wheels.

**Type "B" Piers**

1. All "B" piers shall be 8"x16" blocks with cells placed in vertical position.
2. All piers shall be placed no greater than ten (10) feet apart.
3. All piers shall have solid caps, use treated or hardwood 2"x8" or 2"x10" boards or solid cement blocks.
4. Shims or wedges shall be of treated or hardwood and no greater than two (2) inches in height.

- A. 16"x16" blocks or two (2) 8"x16" blocks.
- B. 8"x16" blocks.
- C. No greater than ten (10) feet between blocks.

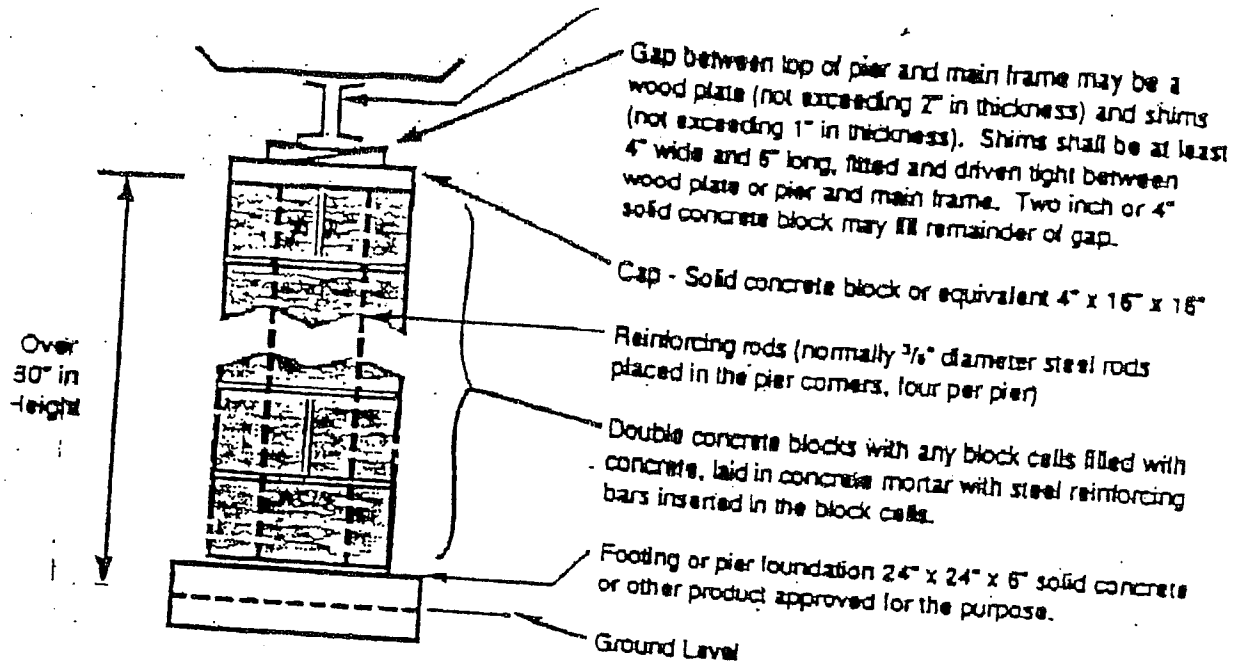

Figure 83(a)

Footings placed on firm undisturbed soil or on compacted fill free of grass and organic materials compacted to a minimum load-bearing capacity of 2000 PSF

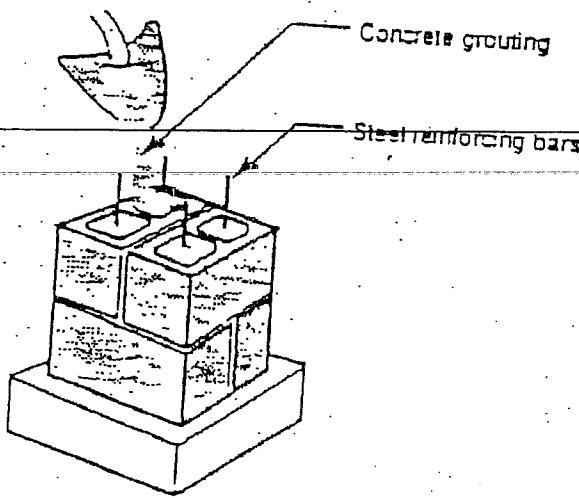

Figure 83(b) For piers exceeding 80 inch in height the concrete blocks should be filled with concrete grouting and steel reinforcing rods utilized.

## TIE DOWNS AND ANCHORS (SPECIFICATIONS TABLE)

(A) LENGTH OF HOME (FT.)	(B) NO. OF VERTICAL TIES	(C) NO. OF DIAGONAL TIES/PER SIDE	MIN. NUMBER OF ANCHORS
Up to 40	2	4	8
40 to 46	2	4	8
46 to 49	2	5	10
49 to 54	3	5	10
54 to 58	3	5	10
58 to 64	3	6	12
64 to 70	3	6	12
70 to 73	3	7	14
73 to 84	4	7	14

2. Double-section manufactured homes require only the diagonal ties specified in Column C.
2. Length of manufactured home (as used in the above table) means length excluding draw bar.
3. Double sections will be bolted together by manufacturer requirements.

### VARIOUS METHODS OF TIE DOWNS

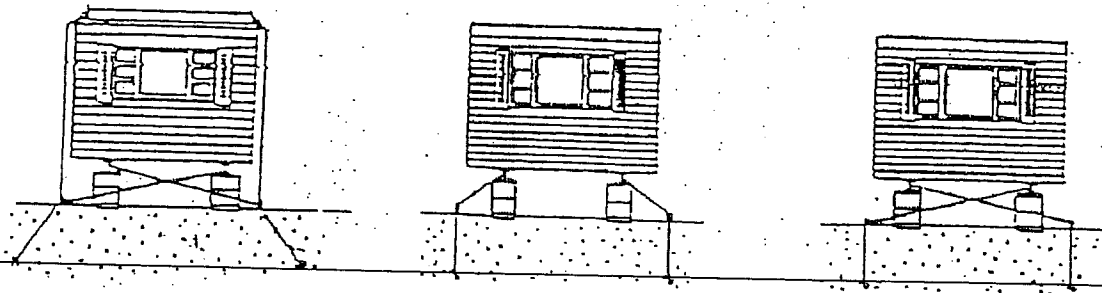

\* DOUBLE WIDES DO NOT  
REQUIRE OVER THE TOP TIE DOWNS

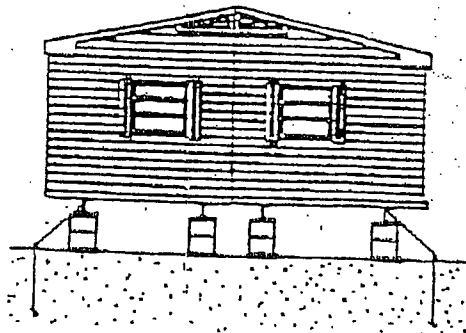

## LANDING AND STAIRS

All mobile homes shall provide a stair and ledge or landing at each exterior door to the mobile home. Stairs shall be at least 36 inches wide. If more than 30 inches high, then a handrail with pickets must be installed.

Landing shall be a minimum of 3 feet by 3 feet and the landing shall not be more than 1½ inches lower than the threshold.

Exception:

1. The landing at the exterior door shall not be more than 7 ¾ inches below the top of the threshold, provided the door does not swing out over the landing.
2. Exterior storm and screen doors do not count as the door swinging over the landing (only the actual entrance door itself).

Construction of stairs and landings shall conform to standards as found in the most recent edition of the International Residential Code.

