

NOTICE

The Union County Council will hold their regular monthly meeting on Tuesday, August 08, 2023 in the Grand Jury Room at the Courthouse at 210 West Main Street at 5:30 p.m. The public is invited to attend and the meeting will be live streamed to www.facebook.com/GearUpUnionSC.

AGENDA
REGULAR MONTHLY MEETING OF THE UNION COUNTY COUNCIL
GRAND JURY ROOM AT 210 W. MAIN STREET
UNION, S. C. 29379
TUESDAY, AUGUST 8, 2023 at 5:30 p.m.
Live Stream to www.facebook.com/GearUpUnionSC

Call to Order.
Invocation and Pledge of Allegiance.
Roll Call.
Approval of Minutes
Service Awards

Chamber of Commerce to discuss Retail Strategies Invoice
Consider approval of Retail Strategies Invoice

Elected Officials:

Treasurer – Deborah E. Robertson
Auditor – Brad Valentine
Clerk of Court – Melanie Lawson
Probate Judge – Toni Allen
Sheriff – Jeff Bailey
Coroner- William Holcombe

Resolution to execute a Ground Lease between Union County and Silver Hawk LLC, for the purpose of constructing and maintaining a waste and recycling convenience center on John Hart in Union County.

Resolution to provide local match if awarded CBDG funding for Aerial Fire Truck in Bonham Fire District.

Resolution supporting a petition by residents of the Rockport Subdivision for annexation into Union County from Spartanburg County, and to request Governor McMaster to appoint a commission for Annexation.

Supervisor's Report.
Call for other Committee Reports.
Council announcements.
Adjourn.

RESOLUTION NO. _____

AUTHORIZING UNION COUNTY, SOUTH CAROLINA, TO EXECUTE AND DELIVER A GROUND LEASE BY AND BETWEEN UNION COUNTY, AS LESSEE, AND SILVER HAWK, LLC, AS LESSOR, FOR THE PURPOSES OF CONSTRUCTING AND MAINTAINING A WASTE AND RECYCLING CONVENIENCE CENTER UPON CERTAIN REAL PROPERTY LOCATED ON JOHN HART ROAD; AND OTHER MATTERS RELATING THERETO.

BE IT RESOLVED BY THE COUNTY COUNCIL OF UNION COUNTY, SOUTH CAROLINA, AS FOLLOWS:

Section 1. Findings and Determinations. The County Council (the "Council") of Union County, South Carolina (the "County"), hereby finds and determines:

(a) Pursuant to Section 4-9-10, Code of Laws of South Carolina 1976, as amended (the "South Carolina Code"), the County operates under the Council-Supervisor form of government and the Council constitutes the governing body of the County.

(b) Section 4-9-30 of the South Carolina Code empowers all counties to acquire and lease real property and to make and execute contracts.

(c) The County desires to enter into a Ground Lease agreement (the "Ground Lease") with Silver Hawk, LLC (the "Lessor") to allow for the construction, operation and maintenance of a household solid waste and recycling materials collection center and facility.

(d) It is in the best interest of the County to enter into the Ground Lease. The Ground Lease will enable the County to provide services necessary or useful to the operations of the County government.

Section 2. Approval of Ground Lease. Without further authorization, the Union County Supervisor (the "County Supervisor") is authorized to negotiate the Ground Lease, approve the form, terms and provisions of the Ground Lease, and to execute and deliver the Ground Lease in the name of and on behalf of the County. The Ground Lease is to be in the form attached hereto in Exhibit A or such other form as shall be approved by the County Supervisor, the County Supervisor's execution thereof to constitute conclusive evidence of such approval.

Section 3. Execution of Documents. The County Supervisor and Clerk to County Council are fully empowered and authorized to take such further action and to execute and deliver such additional documents as may be reasonably requested by the Lessor, or desired by the County Supervisor on advice of legal counsel to the County, to effect the delivery of the Ground Lease in accordance with the terms and conditions therein set forth, and the transactions contemplated hereby and thereby, and the action of such officers in executing and delivering any of such documents, in such form as the County Supervisor shall approve, is hereby fully authorized.

Section 4. Severability. All resolutions and parts thereof, procedural or otherwise, in conflict herewith or the proceedings authorizing the execution of the Lease Agreement are, to the extent of such conflict, hereby repealed.

Section 5. Effective Date. This Resolution shall be effective upon its adoption by the Council of Union County, South Carolina.

[Execution Page Follows]

ADOPTED in meeting of County Council of Union County, South Carolina, duly assembled this
_____, 2023.

UNION COUNTY, SOUTH CAROLINA

(SEAL)

By: _____
County Supervisor
Union County, South Carolina

ATTEST:

By: _____
Clerk to Union County Council
Union County, South Carolina

Exhibit A

Ground Lease

[Insert Ground Lease]

GROUND LEASE

THIS GROUND LEASE ("Lease") is made and entered into by Silver Hawk, LLC, as lessor ("Lessor") and Union County, South Carolina, as lessee ("Lessee"), dated as of _____, 2023.

RECITALS

A. Lessor is the fee simple owner of land located in Union County, South Carolina which is more fully described on **Exhibit A** attached hereto and incorporated herein by reference, subject to all easements, restrictions, rights of way and encroachments of record (the "Lessor Property").

B. Lessor desires to lease a portion of the Lessor Property (the "Ground Lease Premises"), which is more fully described and shown on **Exhibit B** attached hereto and incorporated herein by reference, to Lessee, and Lessee desires to lease the Ground Lease Premises from Lessor to allow for the construction, operation and maintenance (collectively, the "Project") of a household solid waste and recycling materials collection center and facility and other related improvements and infrastructure, including, without limitation, all compactors, waste and recycle boxes, and utility buildings (collectively, the "Convenience Center") at the Ground Lease Premises.

NOW, THEREFORE, in consideration of the mutual covenants and promises of the parties, the receipt and sufficiency of which are hereby acknowledged, the parties hereto agree that the foregoing recitals are true and correct and incorporated herein by this reference, and further agree as follows:

ARTICLE 1 - DEMISE OF GROUND LEASE PREMISES

Section 1.1. Ground Lease Premises. Lessor, for and in consideration of the covenants and conditions herein set forth, does hereby lease to Lessee, and Lessee does hereby lease from Lessor, the Ground Lease Premises, subject to the terms, conditions and provisions hereof.

ARTICLE 2 - LEASE TERM

Section 2.1. Lease Commencement. The effective commencement date of this Lease (the "Lease Commencement Date") shall be _____, 2023.

Section 2.2. Lease Term. The term of this Lease shall be for a period of thirty (30) years and shall continue in effect until midnight, _____, 2053 (the "Expiration Date"), unless earlier terminated as provided herein.

Section 2.3. Termination Prior to Expiration Date. At any time prior to the Expiration Date, Lessee may, at Lessee's election, terminate this Lease one hundred eighty (180) days after written notice thereof by Lessee to Lessor. If at any time prior to the Expiration Date, the Lessee no longer uses the Ground Lease Premises for the Project or other use approved by Lessor (as provided in Section 4.1 herein), Lessor may terminate this Lease one hundred eighty (180) days after written notice thereof by Lessor to Lessee, unless Lessee can reasonably demonstrate the use of the Ground Lease Premises for the Project or other approved use.

Section 2.4. Reversion. Lessor covenants and agrees that no part of the infrastructure or improvements constructed, erected, or placed by Lessee on the Ground Lease Premises, specifically including, without limitation, the Convenience Center, shall be or become, or be considered as being, affixed to or a part of Ground Lease Premises; and any and all provisions and principles of law to the contrary notwithstanding, Lessor specifically intends to covenant and agree and does hereby covenant and agree that all personal property, improvements and infrastructure of every kind and nature constructed, erected, or placed by Lessee on the Ground Lease Premises, specifically including, without limitation, the Convenience Center, shall be and remain the property of Lessee despite any termination of this Lease. Upon the expiration of the term or the earlier termination of the Lease and in accordance with Section 10.1

herein, all improvements and infrastructure upon the Ground Lease Premises, specifically including, without limitation, the Convenience Center, shall be removed by the Lessee.

ARTICLE 3 - RENT, TAXES AND UTILITIES

Section 3.1. Rent. Commencing on the Rent Commencement Date and continuing thereafter throughout the Lease Term, Lessee hereby agrees to pay Lessor an annual payment of one thousand dollars (\$1,000.00) (the "Rent"). Rent shall be due and payable on the anniversary of the Lease Commencement Date. Lessee hereby agrees to pay such Rent to Lessor at Lessor's address as provided herein yearly in advance.

Section 3.2. Taxes. Lessee shall be responsible for any and all real property taxes or fee payments, if any, which are attributable to the Ground Lease Premises during the term of this Lease.

Section 3.3. Utilities. From and after the Lease Commencement Date, Lessee shall pay or cause to be paid any and all charges for water, heat, gas, electricity, cable, trash disposal, and any and all other utilities used by Lessee and its agents upon the Ground Lease Premises during the term of this Lease, including without limitation any connection and servicing fees, permit fees, inspection fees, and fees to reserve utility capacity. Lessor agrees to work with the utility companies and Lessee to allow Lessee to have access to the utilities needed by Lessee at the Ground Lease Premises.

Section 3.4. No Security Deposit. No security deposit is required hereunder.

ARTICLE 4 - USE AND ACCESS

Section 4.1. Permitted Uses. Lessor shall allow Lessee, its agents and employees, to use the Ground Lease Premises for the Project and related improvements and infrastructure and for no other purpose unless written consent for such other purpose is given by the Lessor.

Section 4.2. Access. Lessor shall allow Lessee access to the Ground Lease Premises for the Project, and Lessor shall specifically allow Lessee and Lessee's agents, licensees and invitees vehicular (including, without limitation, trucks and construction equipment) and pedestrian ingress and egress to and from John Hart Road (S-44-220) to and from the Ground Lease Premises, over, across and upon the Lessor Property.

Section 4.3. Temporary Construction and Access Easement. The Lessor, in consideration of ten dollars (\$10.00), and other valuable consideration, has granted, and by these presents does grant, unto Lessee, and Lessee's agents, a limited temporary construction and access easement to the Lessor Property (the "Construction Easement"). The area subject to the Construction Easement is approximately .67 acres (the "Construction Easement Area") and the approximate location of the Construction Easement Area is shown and depicted in yellow on **Exhibit C** attached hereto and incorporated herein by reference. The Construction Easement is for the use of Lessee, and Lessee's agents, for the limited purpose of grading the Lease Premises and the Construction Easement Area and for Lessee remove soil from the Construction Easement Area and relocate said soil to the Lease Premises as fill material. Lessor acknowledges and agrees that the use of the Construction Easement and the work performed on the Construction Easement Area shall be performed in Lessee's sole discretion, including without limitation, the scope of the work, the volume of the removal and relocation of the soil and the grading of the Construction Easement Area. Lessee shall cause all work to be performed on the Construction Easement Area in a good and workmanlike manner and in compliance with all applicable governmental permits, laws, ordinances, and regulations. Upon completion of the work performed within the Construction Easement Area, Lessee shall seed the disturbed portions of the Construction Easement Area to provide reasonable ground cover. The Construction Easement shall automatically expire upon completion of the work, but in no event shall it extend beyond two hundred seventy (270) days from the Lease Commencement Date.

ARTICLE 5 - IMPROVEMENTS

Section 5.1. **Improvements.** Lessee will, at its own cost and expense, construct the Project, and improvements and infrastructure upon the Ground Lease Premises, specifically including, without limitation, the Convenience Center, and fences or barriers to prevent unauthorized access to the Ground Lease Premises and the Project. Lessee shall cause all work to be performed in a good and workmanlike manner and in compliance with all applicable governmental permits, laws, ordinances, and regulations, including any applicable regulations and guidelines of the South Carolina Department of Health and Environmental Control.

ARTICLE 6 – MAINTENANCE

Section 6.1. **Maintenance of Ground Lease Premises.** Lessee will, at its own cost and expense, maintain or cause to be maintained the Ground Lease Premises, the Project, and any other related improvements and infrastructure, in good order, condition and repair and in compliance with all applicable governmental permits, laws, ordinances, and regulations, including any applicable regulations and guidelines of the South Carolina Department of Health and Environmental Control.

ARTICLE 7 - ASSIGNMENT AND SUBLETTING

Section 7.1. **Limitation on Assignment and Subletting.** Except as otherwise provided herein, neither Lessee nor Lessor may sell, assign, sublease, convey or transfer its interest in this Lease and the leasehold estate created hereby, without the prior written consent of the other party.

ARTICLE 8 - INSURANCE AND INDEMNIFICATION

Section 8.1. **Comprehensive Liability Insurance.** Lessee represents that it holds and maintains a general policy of liability insurance as required of local governments under South Carolina law.

Section 8.2. **Indemnification.** Lessor hereby agrees to indemnify, protect, defend and save Lessee and its council members, officers, employees, agents, and attorneys harmless from and against any and all losses, damages, actions, fines, penalties, demands, damages, liability and expense, including attorneys' fees and costs through litigation and all appeals, in connection with the loss of life, personal injury and damage to property, resulting from the negligence or intentional misconduct of Lessor, its employees or agents, arising from or out of any occurrence in, upon, at or about the Ground Lease Premises. Nothing contained herein shall be construed to make Lessor liable for any injury or loss caused by the gross negligence or willful misconduct of Lessee or any agent or employee of Lessee.

ARTICLE 9 - DAMAGE AND DESTRUCTION

Section 9.1. **Lessee's Right to Restore the Ground Lease Premises.** At any time during the Term, or any extensions thereof, if any improvements or infrastructure now or hereafter located on the Ground Lease Premises are damaged or destroyed in whole or in part by fire, theft, the elements, or any other cause, this Lease shall continue in full force and effect unless terminated by Lessee upon ninety (90) days written notice, and Lessee, at its sole cost and expense, shall have the right to repair and restore the damaged or destroyed improvements and infrastructure according to the original plan or according to such modified plans as shall be reasonably determined by Lessee in its sole discretion. The work of repair and restoration shall be commenced by Lessee as soon as possible after the damage or destruction occurs, and shall be completed with due diligence.

ARTICLE 10 - SURRENDER AND REMOVAL

Section 10.1. **Surrender of Possession.** Upon the expiration of the Term, or any earlier termination thereof, Lessee shall surrender to Lessor its leasehold interest in the Ground Lease Premises. All improvements and infrastructure upon the Ground Lease Premises, specifically including, without

limitation, the Convenience Center, shall be removed by the Lessee on or before the ninetieth (90th) day after the Expiration Date or sooner termination of this Lease. Lessee shall restore the surface of the ground to approximately the grade and shape of the surrounding land or as mutually agreed upon by both parties.

ARTICLE 11 – GENERAL PROVISIONS

Section 11.1. Conditions and Covenants. All of the provisions of this Lease shall be deemed as running with the land, and construed to be “conditions” as well as “covenants” as though the words specifically expressing or imparting covenants and conditions were used in each separate provision.

Section 11.2. Survival of Indemnities. All representations, warranties and indemnities of Lessor under this Lease shall survive the expiration or sooner termination of this Lease for acts occurring prior to expiration or termination of this Lease.

Section 11.3. No Waiver of Breach. No failure by either Lessor or Lessee to insist upon the strict performance by the other of any covenant, agreement, term or condition of this Lease, or to exercise any right or remedy consequent upon a breach thereof, shall constitute a waiver of any such breach or of such covenant, agreement, term or condition. No waiver of any breach shall affect or alter this Lease, but each and every covenant, condition, agreement and term of this Lease shall continue in full force and effect with respect to any other then existing or subsequent breach.

Section 11.4. Unavoidable Delay - Force Majeure. If either party shall be delayed or prevented from the performance of any act required by this Lease by reason of acts of God, strikes, lockouts, labor troubles, inability to procure materials, restrictive governmental laws, or regulations or other cause, without fault and beyond the reasonable control of the party obligated (financial inability excepted), performance of such act shall be excused for the period of the delay; and the period for the performance of any such act shall be extended for a period equivalent to the period of such delay.

Section 11.5. Notices. Unless otherwise specifically provided in this Lease or by law, any and all notices or other communications required or permitted by this Lease or by law to be served on, given to, or delivered to any party to this Lease shall be writing and shall be deemed duly served, given, delivered and received when personally delivered (including confirmed overnight delivery service to the party to whom it is directed), or in lieu of such personal delivery, when three (3) business days have elapsed following deposit thereof in the United States mail, first-class postage prepaid, certified, return receipt requested, addressed to:

LESSOR: Silver Hawk, LLC
PO Box 1087
Travelers Rest, SC 29690

LESSEE: Union County, South Carolina
210 West Main Street
Union, SC 29379
Attn: County Supervisor

Either party may change its address for the purpose of this Section by giving written notice of such change to the other party in the manner provided in this Section.

Section 11.6. Captions. Captions in this Lease are inserted for convenience of reference only and do not define, describe or limit the scope or the intent of this Lease or any of the terms hereof.

Section 11.7. Waiver; Amendment. No modification, waiver, amendment, discharge or change of this Lease shall be valid unless the same is in writing and signed by the party against which the enforcement of such modification, waiver, amendment, discharge or change is or may be sought.

Section 11.8. Attorneys' Fees. If either party retains an attorney to enforce or interpret this Lease, the prevailing party shall be entitled to recover, in addition to all other items of recovery permitted by law, reasonable attorneys' fees and costs incurred through litigation, bankruptcy proceedings and all appeals.

Section 11.9. Time. Time is of the essence of each obligation of each party hereunder.

Section 11.10. Governing Law. This Lease shall be construed and enforced in accordance with the laws of the State of South Carolina, without regard to conflict of law principles.

Section 11.11. Binding Effect. Subject to any provision of this Lease that may prohibit or curtail assignment of any rights hereunder, this Lease shall bind and inure to the benefit of the respective heirs, assigns, personal representatives, and successors of the parties hereto.

Section 11.12. Execution of Other Instruments. Each party agrees that it shall, upon the other's request, take any and all steps, and execute, acknowledge and deliver to the other party and all further instruments necessary or expedient to effectuate the purpose of this Lease.

Section 11.13. Severability. If any term, provision, covenant or condition of this Lease is held by a court of competent jurisdiction to be invalid, void or unenforceable or is otherwise challenged and determined to be invalid, illegal or incapable of being enforced as a result of any rule of law or public policy issued by an administrative or judicial forum that is not subject to further appeal or is not actually appealed, the remainder of the provisions shall remain in full force and effect and shall in no way be affected, impaired or invalidated. In such event or if an opinion of counsel is provided to the effect that this Lease is not so enforceable, the parties hereto shall negotiate in good faith to modify this Lease so as to effect the original intent of the parties as closely as possible and to comply with applicable law, regulations or published governmental interpretations thereof, in an acceptable manner to the end that the transactions contemplated hereby are fulfilled to the extent possible.

Section 11.14. Counterparts. This Lease may be executed in one or more counterparts, each of which shall be deemed an original and when taken together will constitute one instrument.

Section 11.15. Estoppel Certificate. Either party shall execute, acknowledge and deliver to the other party, within twenty (20) days after requested by the other party, a statement in writing certifying, if such is the case, that this Lease is unmodified and in full force and effect (or if there have been modifications that the same is in full force and effect as modified); the date of the commencement of this Lease; any alleged defaults and claims against the other party; and such other information as shall be reasonably requested.

Section 11.16. Memorandum of Lease. On or before the Lease Commencement Date, Lessor and Lessee shall execute and acknowledge a memorandum of this Lease for the purpose of recordation. The memorandum of this Lease shall be in the form attached hereto as **Exhibit D** and incorporated herein by reference.

Section 11.17. Waiver of Trial by Jury. LESSOR AND LESSEE MUTUALLY, EXPRESSLY, IRREVOCABLY AND UNCONDITIONALLY WAIVE TRIAL BY JURY FOR ANY PROCEEDINGS ARISING OUT OF OR IN CONNECTION WITH THIS LEASE, OR ARISING OUT OF ANY CONDUCT OR COURSE OF DEALING OF THE PARTIES, STATEMENTS (WHETHER ORAL OR WRITTEN) OR ACTIONS OF ANY PERSONS. THIS WAIVER IS A MATERIAL INDUCEMENT TO LESSEE AND LESSOR TO ENTER INTO THIS LEASE.

THE REMAINDER OF THIS PAGE IS INTENTIONALLY LEFT BLANK.

This Lease has been executed as of the day and year first above written.

LESSOR:

Silver Hawk, LLC

By: _____

Name: _____

Title: _____

LESSEE:

Union County, South Carolina

By: _____

Name: Phillip Russell

Title: County Supervisor

EXHIBIT A

LEGAL DESCRIPTION OF LESSOR PROPERTY

All that certain piece, parcel or tract of land with any improvements thereon lying and being situated in Union County, South Carolina, containing 29.85 acres, more or less, as shown on a plat prepared for Silver Hawk, LLC by William Keith Roark, RLS, dated June 6, 2012 and recorded in the Union County Clerk of Court's Office in Plat Cabinet B Slide 84, Page 7. Said plat is incorporated herein by reference for a more detailed description of said tract of land. Said lands bounded generally as follows: on the north by John Hart Road, on the east by property now or formerly of Owens, on the south by property now or formerly of Silver Hawk, LLC, on the west by Mitchell Creek.

DERIVATION: This being the same property conveyed to Silver Hawk, LLC by deed of Pine Valley Farms 2, LLC, dated June 14, 2012, and recorded in the Office of the Clerk of Court of Union County, South Carolina on June 14, 2012 in Deed Book 242, Page 387.

Union County Tax Map # 062-00-00-020

EXHIBIT B

DESCRIPTION OF GROUND LEASE PREMISES

All that certain piece, parcel or tract of land with any improvements thereon lying and being situated in Union County, South Carolina, containing 3.00 acres, more or less, as shown on a plat dated September 23, 2022, prepared for Union County by Robert W. Drummond, PLS # 22743 of Palmetto Corp, Job # G2021, and having the following metes and bounds to wit:

BEGINNING at an iron pin on the right-of-way of John Hart Road (S-44-220) being 33 feet from the center line of John Hart Road (S-44-220) and being the north east corner of the land and thence running 170.00 feet S 19-45-13 W to an iron pin; thence turning and running 112.24 feet S 46-34-27 W to an iron pin; thence turning and running 300.00 feet N 70-12-45 W to an iron pin; thence turning and running 183.70 feet N 27-14-58 W to an iron pin; thence turning and running 75.00 feet N 70-12-45 W to an iron pin; thence turning and running 145.00 feet N 19-45-13 E to an iron pin on the right-of-way of John Hart Road (S-44-220) being 33 feet from the center line of John Hart Road (S-44-220) and being the north west corner of the land; thence turning and running along the right-of-way of John Hart Road (S-44-220) 560.00 feet S 70-12-45 E to the POINT OF BEGINNING.

EXHIBIT C

DEPICTION OF CONSTRUCTION EASEMENT AREA

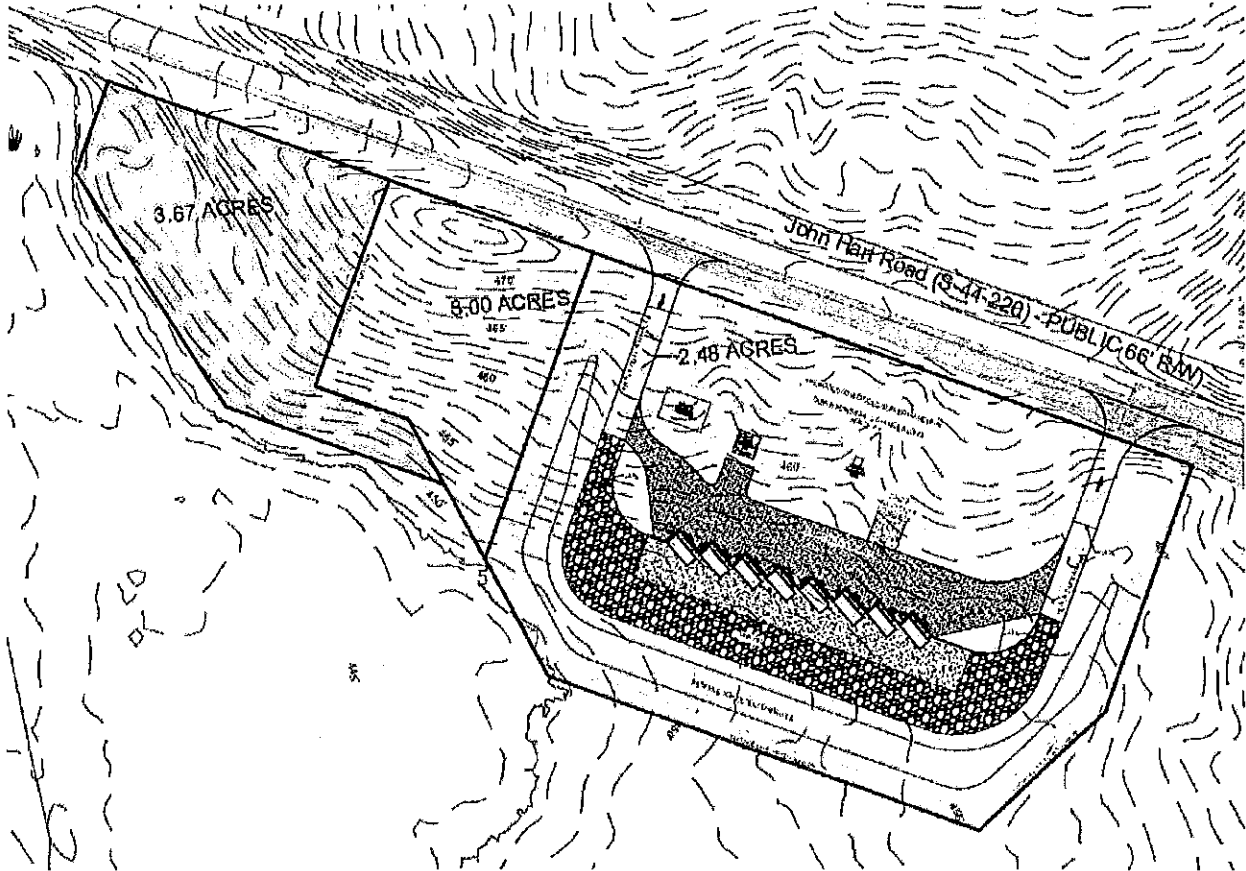

The above depiction is solely for the purpose of indicating and showing the approximate location of the 0.67 acre portion of the Lessor Property that is the Construction Easement Area. The Construction Easement Area is shown in yellow. This depiction shall not be used by any party for any other purposes, including as a reference to the Ground Lease Premises, the Project, or any infrastructure to be placed on the Ground Lease Premises.

EXHIBIT D

MEMORANDUM OF LEASE

(see *attached*)

STATE OF SOUTH CAROLINA)

COUNTY OF UNION)

MEMORANDUM OF GROUND LEASE

THIS MEMORANDUM OF GROUND LEASE is made as of _____, 2023, between UNION COUNTY, SOUTH CAROLINA, hereinafter referred to as "Lessee" and SILVER HAWK, LLC, hereinafter referred to as "Lessor".

1. Lessor and Lessee entered into a certain Ground Lease, dated _____, 2023 (the "Ground Lease").
2. The property demised under the Ground Lease is a portion of the land located in the County of Union, State of South Carolina, and more particularly described as:

All that certain piece, parcel or tract of land with any improvements thereon lying and being situated in Union County, South Carolina, containing 29.85 acres, more or less, as shown on a plat prepared for Silver Hawk, LLC by William Keith Roark, RLS, dated June 6, 2012 and recorded in the Union County Clerk of Court's Office in Plat Cabinet B Slide 84, Page 7. Said plat is incorporated herein by reference for a more detailed description of said tract of land. Said lands bounded generally as follows: on the north by John Hart Road, on the east by property now or formerly of Owens, on the south by property now or formerly of Silver Hawk, LLC, on the west by Mitchell Creek.

DERIVATION: This being the same property conveyed to Silver Hawk, LLC by deed of Pine Valley Farms 2, LLC, dated June 14, 2012, and recorded in the Office of the Clerk of Court of Union County, South Carolina on June 14, 2012 in Deed Book 242, Page 387.

Union County Tax Map # 062-00-00-020

3. The commencement date of the Ground Lease is _____, 2023. The term of the Ground Lease shall be for a period of thirty (30) years and shall continue in effect until midnight, _____, 2053, unless earlier terminated as provided for in the Ground Lease.
4. The Ground Lease is on file at the offices of Lessee at:
Union County, South Carolina
210 West Main Street
Union, SC 29379
5. All of the terms, conditions, provisions and covenants of the Ground Lease are incorporated herein by reference as though set forth at length, and the Ground Lease and this Memorandum of Ground Lease shall be deemed to constitute a single document.

THE REMAINDER OF THIS PAGE IS INTENTIONALLY LEFT BLANK.

SIGNATURE PAGES TO FOLLOW

IN WITNESS WHEREOF, Lessor and Lessee have caused this Memorandum of Ground Lease to be executed and delivered as of the day and year first above written.

SIGNED, SEALED and delivered in
the presence of:

LESSEE:

Union County, South Carolina

Print Name: _____
Witness #1

_____(SEAL)
By: Phillip Russell
Its: County Supervisor

Print Name: _____
Witness #2/Notary

STATE OF SOUTH CAROLINA)
COUNTY OF UNION)

ACKNOWLEDGEMENT

The foregoing instrument was acknowledged before me this _____, 2023 by Phillip Russell the County Supervisor of Union County, South Carolina, on behalf of Union County, South Carolina.

Notary Public Signature

Notary Public Printed Name
Notary Public for: _____
My Commission expires: _____

[NOTARIAL SEAL]

SIGNED, SEALED and delivered in
the presence of:

LESSOR:

Silver Hawk, LLC

Print Name: _____
Witness #1 _____

By: _____
Its: _____

Print Name: _____
Witness #2/Notary _____

STATE OF _____)
COUNTY OF _____)

ACKNOWLEDGEMENT

The foregoing instrument was acknowledged before me this _____, 2023 by
_____ [name of officer] the _____ [title of officer] of
Silver Hawk, LLC a South Carolina limited liability company, on behalf of the company.

Notary Public Signature

Notary Public Printed Name

Notary Public for: _____

My Commission expires: _____

[NOTARIAL SEAL]

STATE OF SOUTH CAROLINA)
)
COUNTY OF UNION)

RESOLUTION

WHEREAS, Union County, South Carolina, has identified the need for an Aerial Fire Truck in order to continue to provide adequate fire service to the residents in the Bonham Fire District; and,

WHEREAS, the proposed aerial fire truck is necessary to provide better fire protection in locations that are hard to reach with a standard pumper truck; and,

WHEREAS, Union County is currently relying on the City of Union's aerial fire truck and does not own an aerial truck; and,

WHEREAS, the proposed aerial fire truck is necessary to improve the County's ISO rating; and,

WHEREAS, the estimated costs of the new truck and equipment to place the truck in service is \$1,400,000; and

WHEREAS, Union County intends to make an application for \$750,000 in Community Development Block Grant funding through the Community Enrichment Program to pay for the new aerial fire truck; and,

WHEREAS, this program requires local matching funds of at least 10 percent of the grant amount; and,

WHEREAS, Union County understands that any cost savings that may result from the competitive bidding process of the project will be shared with the South Carolina Department of Commerce, Office of Grants Administration; and,

NOW, THEREFORE BE IT RESOLVED, the Union County Council, in Council assembled, hereby agrees to provide a local match of \$675,000 and any additional funds required for the completion of the project.

ADOPTED THIS THE 8th DAY OF AUGUST 2023.

BY: _____
Phillip Russell, Supervisor
Union County

ATTEST: _____

UNION COUNTY
RESOLUTION 2023-_____

**A UNION COUNTY RESOLUTION SUPPORTING THE PETITION OF ROCKPORT
SUBDIVISION FOR ANNEXATION INTO UNION COUNTY FROM SPARTANBURG
COUNTY AND A RECIPROCAL REQUEST OF GOVERNOR HENRY MCMASTER
TO APPOINT A COMMISSION FOR ANNEXATION PURSUANT TO SECTION 4-5-
130 OF THE SOUTH CAROLINA CODE OF LAWS ANNOTATED, 1976, AS
AMENDED.**

WHEREAS, the South Carolina General Assembly authorized the Revenue and Fiscal Affairs Geodetic Survey Group to verify county lines throughout the State of South Carolina based on historical records and the benefit of modern technology; and

WHEREAS, as a result of these surveys it was discovered that areas formerly treated as a part of Union County along its boundary line with Spartanburg County were actually a part of Spartanburg County; and

WHEREAS, Union County has been made aware of a certain petition signed by the entirety of Rockport Subdivision, wherein these former citizens wish to be annexed back into Union County; and

WHEREAS, Union County contacted Spartanburg County to discern whether there would be opposition to such a petition or request and is under the belief that such action would be beneficial for all involved;

NOW, THEREFORE, IT IS HEREBY RESOLVED BY UNION COUNTY, ACTING BY AND THROUGH ITS GOVERNING BODY, THE UNION COUNTY COUNCIL, that:

1. Union County Council formalizes its support of the Petition for Annexation executed by the residents of Rockport Subdivision; and
2. Union County Council further requests that Governor Henry McMaster appoint a Commission for Annexation to investigate all facts relating to the area, population, property values, proximity, and indebtedness, in addition to all such other matters relevant to a proposed annexation in accordance with South Carolina law; and
3. Should any portion of this Resolution be deemed unconstitutional or otherwise enforceable by any court of competent jurisdiction, such determination should not affect the remaining terms and provisions of this resolution, all of which are hereby deemed separable.
4. All orders, resolutions and enactments of Union County Council inconsistent herewith are to the extent of such inconsistency only, hereby repealed, revoked and rescinded.
5. This Resolution shall take effect and be in full force and effect after enactment by Union County Council.

RESOLVED in meeting duly assembled, this ____ day of _____, 2023.

UNION COUNTY, SOUTH CAROLINA

By: _____
Phillip G. Russell, II, Union County
Supervisor, Union County, South
Carolina

ATTEST:

By: _____
Kindra Horne, Clerk to Union County Council
Union County, South Carolina

Monthly Update Report from Finance for August Council Meeting:

- Financials were included in Council packets for the 13th month period ending June 30, 2023 (100.0% of the year, noting Period 13 activity is included).
 - Revenues are calculated at a percentage higher than last year, 89.5% vs 86.5%. Regular tax payment receipts are seeing a short-fall to date of approximately \$750,000.
- Expenditures through Period 13 2023 are at 90.7%, which is on target from time-line standpoint. There may be some acceleration in cost in the final quarter based on the increases we are seeing in fuel and food items.
- Quarterly Grant update reports are up-to date as of July.
- Preliminary work is beginning on the 2023 audit.

UNION COUNTY SC
BUDGET TO ACTUAL VARIANCE

		2022-2023 BUDGET	PERIOD 13 FY 2023 ACTUAL	VARIANCE	%-AGE OF BUDGET
REVENUES					
TAXES					
REAL ESTATE TAXES	101-0000-301-0000	8,100,000.00	7,380,590.87	719,409.13	91.12%
VEHICLE TAXES	101-0000-302-0000	1,250,000.00	1,118,645.19	131,354.81	89.49%
FILOT - COUNTY OPERATIONS	101-0000-302-0000	50,000.00		50,000.00	0.00%
WATERCRAFT	101-0000-302-0000	35,000.00	48,246.99	(13,246.99)	137.85%
LOST TAX	101-0000-302-0000	1,900,000.00		1,900,000.00	0.00%
		11,335,000.00	8,547,483.05	2,787,516.95	75.41%
FINES					
MAGISTRATE	101-0000-311-0000	90,000.00	99,247.93	(9,247.93)	110.28%
CLERK OF COURT - GEN SESSIONS	101-0000-312-0000	8,000.00	2,055.05	5,944.95	25.69%
NSF-MAG FINE	101-0000-313-0000	-	-	-	#DIV/0!
COC-BOND ESTREATMENT	101-0000-322-0000	-	-	-	#DIV/0!
		98,000.00	101,302.98	(3,302.98)	103.37%
FEES					
MAGISTRATE - CIVIL COSTS	101-0000-323-1000	52,500.00	53,460.00	(960.00)	101.83%
TAX ASSESSOR FEES	101-0000-323-1100			-	#DIV/0!
CLERK OF COURT FEES	101-0000-323-1300	125,000.00	191,249.39	(66,249.39)	153.00%
CLERK OF COURT COLL FEES	101-0000-323-1400	750.00	562.55	187.45	75.01%
PROBATE JUDGE FEES	101-0000-323-2000	35,000.00	29,214.99	5,785.01	83.47%
DEL TAX COLLECTION FEES	101-0000-323-2500	60,000.00	(190.00)	60,190.00	-0.32%
WORTHLESS CHECK FEES-SOL	101-0000-323-2600	500.00	82.00	418.00	16.40%
CITY CODE ENFORCEMENT	101-0000-323-3800		20,000.00	(20,000.00)	#DIV/0!
CITY ANIMAL CONTROL	101-0000-323-3900	15,000.00	31,000.04	(16,000.04)	206.67%
ANIMAL CONTROL	101-0000-323-4000		785.00	(785.00)	#DIV/0!
ANIMAL SHELTER DONATION	101-0000-323-4200		1,735.00	(1,735.00)	#DIV/0!
SPAY/NEUTER PROGRAM	101-0000-323-4400			-	#DIV/0!
JAIL FEES	101-0000-323-7100	20,000.00	15,147.00	4,853.00	75.74%
BAD CHECK FEES	101-0000-323-7500		70.00		
SHERIFF FEES	101-0000-323-7600	5,000.00	3,204.00	1,796.00	64.08%
FAMILY COURT COST	101-0000-323-7800	75,000.00	63,898.53	11,101.47	85.20%
BUILDING PERMITS	101-0000-323-8000	65,000.00	224,190.04	(159,190.04)	344.91%
VEHICLE DECAL FEE				-	#DIV/0!
LOCAL ASSESSMENT FEES	101-0000-323-9000	2,000.00	54.79	1,945.21	2.74%
TAX DATA FEES	101-0000-323-9500		1,500.00		
CC IP FEES	101-0000-323-9600		9,184.45	(9,184.45)	#DIV/0!
		455,750.00	645,147.78	(189,397.78)	141.56%
STATE & FEDERAL					
MERCHANTS INVENTORY TAX	101-0000-331-1000	55,000.00	54,794.12	205.88	99.63%
STATE SHARED TAXES	101-0000-331-1100	1,150,000.00	1,102,714.19	47,285.81	95.89%
NATIONAL FOREST FUND	101-0000-331-1200	90,000.00	101,920.16	(11,920.16)	113.24%
VOTERS REGISTRATION	101-0000-331-1300	12,000.00	31,155.62	(19,155.62)	259.63%
SOL OFFICE-PUBLIC DEF SAL	101-0000-331-1500			-	#DIV/0!
ASST SOLICITOR'S SALARY	101-0000-331-1600	36,000.00		36,000.00	0.00%
VETERAN'S AFFAIRS	101-0000-331-1700	5,700.00	5,783.57	(83.57)	101.47%
DEPT OF SOCIAL SERVICES	101-0000-331-1800	20,000.00	17,787.36	2,212.64	88.94%
ACCOMMODATIONS TAX - STATE	101-0000-331-1900	150,000.00	174,433.36	(24,433.36)	116.29%
EMERGENCY SERVICES	101-0000-331-2000	8,000.00	18,784.30	(10,784.30)	234.80%
CARNEGIE LIBRARY - STATE	101-0000-331-2400			-	#DIV/0!
CARNEGIE LIBRARY - FEDERAL	101-0000-331-2500			-	#DIV/0!
PILT PROGRAM	101-0000-331-2700		90,188.00	(90,188.00)	#DIV/0!
POLLWORKERS	101-0000-331-3100	70,000.00	20,865.00	49,135.00	29.81%
UNCLAIMED PROPERTY-STATE	101-0000-331-3200				
RURAL COUNTY STABILIZATION	101-0000-331-3500	325,000.00	387,096.76	(62,096.76)	119.11%
		1,921,700.00	2,005,522.44	(83,822.44)	104.36%

UNION COUNTY SC
BUDGET TO ACTUAL VARIANCE

		2022-2023 BUDGET	PERIOD 13 FY 2023 ACTUAL	VARIANCE	%-AGE OF BUDGET
OTHER					
RECREATION DEPARTMENT	101-0000-351-1000	23,000.00	18,475.00	4,525.00	80.33%
RENT - AIRPORT HANGARS	101-0000-351-6000	26,000.00	16,450.00	9,550.00	63.27%
TRANS FUNDS - LOCAL HOSP/ACCOM	101-0000-351-8000	310,000.00		310,000.00	0.00%
TRANSFER IN	101-0000-380-0000	70,000.00	231,341.60	(161,341.60)	330.49%
SUBSCRIBER BILLING	101-0000-380-1000	111,284.00	105,390.86	5,893.14	94.70%
WORKFORCE DEVELOPMENT	101-0000-380-1100		-	-	#DIV/0!
VICTIM'S ADVOCATE	101-0000-380-1200	54,956.00	75,515.91	(20,559.91)	137.41%
COC-TITLE IV-D	101-0000-380-1300	27,179.00	-	27,179.00	0.00%
POLLWORKERS	101-0000-380-1400	66,000.00	-	66,000.00	0.00%
ALCOHOL & DRUG ABUSE	101-0000-380-1500	537,813.00	460,922.03	76,890.97	85.70%
SOLICITOR'S OFFICE	101-0000-380-1600	253,305.00		253,305.00	0.00%
COMMUNITY DEVELOPMENT	101-0000-380-1700	94,344.00	83,678.34	10,665.66	88.69%
SCHOOL RESOURCE OFFICER (NEW)	101-0000-380-1800/391-9600	360,068.00	332,183.71	27,884.29	92.26%
ALCOHOL & DRUG EXPENSES	101-0000-380-2500	145,560.00	104,542.72	41,017.28	71.82%
VICTIM'S ADVOCATE EXPENSES	101-0000-380-2600		5,269.73	(5,269.73)	#DIV/0!
TRANSFER IN - TITLE IV SMALL	101-0000-380-2700	29,900.00	23,074.46	6,825.54	77.17%
TRANSFER FROM E		-			#DIV/0!
TRANSFER FROM BOND FUNDS		100,000.00		100,000.00	0.00%
TRANSFER FROM COMMUNITY DEVELOPMENT		1,000,000.00		1,000,000.00	0.00%
ECONOMIC DEVELOPMENT(SPECIAL)		25,000.00	-	25,000.00	0.00%
TRANSFER TUITION ASSISTANCE		150,000.00		150,000.00	0.00%
TRANSFER FROM ELECTRONIC MONITORING		14,001.00		14,001.00	0.00%
REIMBURSEMENTS	VARIOUS		-	-	#DIV/0!
COMMISSION-VENDING MACH	101-0000-391-0100		-	-	#DIV/0!
STADIUM	101-0000-391-0200	73,568.00	73,570.70	(2.70)	100.00%
TAX NOTICE AMOUNT	101-0000-391-0300	3,600.00	3,495.00	105.00	97.08%
INTEREST INCOME	101-0000-391-0400	35,000.00	1,005,510.26	(970,510.26)	2872.89%
MISCELLANEOUS	101-0000-391-0600		2,313.00	(2,313.00)	#DIV/0!
RENT OF TOWER	101-0000-391-0800	41,000.00	39,125.82	1,874.18	95.43%
FRANCHISE FEES	101-0000-391-1200	75,000.00	74,028.64	971.36	98.70%
AUCTION PROCEEDS	101-0000-391-1300	30,000.00	99,300.82	(69,300.82)	331.00%
CHRISTMAS PARTY DONATIONS	101-0000-391-1500		208.63	(208.63)	#DIV/0!
INTEREST - CO OPER PROVIDENT	101-0000-391-1600	1,000.00	5,127.30	(4,127.30)	512.73%
TIMKEN SPORT COMPLEX REVENUE	101-0000-391-1800	100,000.00	150,000.00	(50,000.00)	150.00%
LANDFILL HOST FEES	101-0000-391-2000	2,100,000.00	2,503,196.23	(403,196.23)	119.20%
GEN ELECTION-CITY & SCHOOL	101-0000-391-2700	-	7,500.00	(7,500.00)	#DIV/0!
ESAB BUILDING RENTAL	101-0000-391-6200	-	-	-	#DIV/0!
REIMBURSEMENT FROM INSURANCE	101-0000-391-3300		46,707.94	(46,707.94)	#DIV/0!
COMMUNICATIONS	101-0000-391-3400		-	-	#DIV/0!
RESTITUTION	101-0000-391-4000		233.66	(233.66)	#DIV/0!
SC WORKS RENT	101-0000-391-4200		-	-	#DIV/0!
SALE OF SCRAP METAL	101-0000-391-4400	30,000.00	29,512.20	487.80	98.37%
STADIUM RENTAL	101-0000-391-4500		87.40	-	#DIV/0!
SALE OF COUNTY PROPERTY	101-0000-391-4600		-	-	#DIV/0!
SALE OF RECYCLING PRODUCTS	101-0000-391-4700	12,430.00		-	#DIV/0!
LITTER GRANT FROM REPUBLIC	101-0000-391-5800		-	-	#DIV/0!
REIMBURSEMENT TAX NOTICE POSTINGS	101-0000-391-5400		-	-	#DIV/0!
EMS OTHER INCOME	101-0000-391-5500		1,671.05	(1,671.05)	#DIV/0!
EMS OTHER INCOME	101-0000-391-5550		-	-	#DIV/0!
EMS TAX LEVY - VEHICLE	101-0000-391-5610		179,206.85	(179,206.85)	#DIV/0!
EMS TAX LEVY - R/E	101-0000-391-5620		1,079,774.23	(1,079,774.23)	#DIV/0!
EMS COLLECTIONS	101-0000-391-5700	1,000,000.00	1,040,399.86	(40,399.86)	104.04%
PHONE COMSRY	101-0000-391-6300		6,281.34	(6,281.34)	#DIV/0!
WHY TRY GRANT-ADA	101-0000-391-6400		-	-	#DIV/0!
WKR'S COMP REIMBU	101-0000-391-6500		-	-	#DIV/0!
ECHO GRANT-ADA	101-0000-391-6600		-	-	#DIV/0!
LANDFILL DONATION-CKFD	101-0000-391-6700	25,000.00	31,250.00	(6,250.00)	125.00%
LOCAL OPTION SALES TAX	101-0000-391-7100	600,000.00	-	600,000.00	0.00%
BREC CAPITAL CREDIT	101-0000-391-7200		-	-	#DIV/0!
FD LOAN REPAYMENTS	101-0000-391-7900		-	-	#DIV/0!
STATE CR-EM/ER RETIREMENT	101-0000-391-8000	72,963.00		72,963.00	0.00%
MED/EDUC BLDG	101-0000-391-8100		-	-	#DIV/0!
CITY GRANT TO DEV BOARD		10,000.00		10,000.00	#DIV/0!
FIREWORKS	101-0000-391-7500/9100		-	-	#DIV/0!
SHIP-COST POOL REFUND	101-0000-391-9000				
LEASE - MYCO WORKS	101-0000-391-9700		28,000.08		
GRANT FOR USED OIL	101-0000-391-9800		950.10		
		7,607,971.00	7,864,295.47	(256,324.47)	103.37%
TOTAL		21,418,421.00	19,163,751.72	2,254,669.28	89.47%

UNION COUNTY SC
BUDGET TO ACTUAL VARIANCE

	2022-2023 BUDGET	PERIOD 13 FY 2023 ACTUAL	VARIANCE	%-AGE OF BUDGET
COUNTY GENERAL FUND	1,347,645.00		1,347,645.00	0.00%
TRANSFER FROM SPECIAL REVENUE	15,000.00		15,000.00	0.00%
PROCEEDS FROM CAPITAL LEASE			-	#DIV/0!
MILLAGE INCREASE	1,362,645.00		1,362,645.00	0.00%
GRAND TOTAL	22,781,066.00	19,163,751.72	3,617,314.28	84.12%

UNION COUNTY SC
BUDGET TO ACTUAL VARIANCE

		2022-2023 BUDGET	PERIOD 13 FY 2023 ACTUAL	VARIANCE	%-AGE OF BUDGET
<u>EXPENDITURES</u>					
SUPERVISOR, COUNCIL, FINANCE & HR					
SALARIES	101-1101-411-11-50	396,439.00	390,115.67	6,323.33	98.40%
SALARIES-SUBSCRIBER BILLING	101-1101-411-11-55	29,698.00	17,664.56	12,033.44	59.48%
INSURANCE	101-1101-411-44-01	108,876.00	72,237.77	36,638.23	66.35%
SOCIAL SECURITY	101-1101-411-44-02	32,600.00	29,307.81	3,292.19	89.90%
RETIREMENT	101-1101-411-44-04	75,329.00	67,197.73	8,131.27	89.21%
WORKERS COMPENSATION	101-1101-411-44-06	5,495.00	6,774.80	(1,279.80)	123.29%
TRAINING	101-1101-411-58-05	14,000.00	5,054.64	8,945.36	36.10%
PRINTING & OFFICE SUPPLIES	101-1101-411-61-01	13,000.00	7,449.53	5,550.47	57.30%
SPECIALIZED DEPARTMENTAL SUPPLIES	101-1101-411-61-02	2,300.00	834.60	1,465.40	36.29%
		677,737.00	596,637.11	81,099.89	88.03%
IT					
SALARIES	101-1102-411-11-50	43,932.00	43,837.46	94.54	99.78%
INSURANCE	101-1102-411-44-01	6,447.00	6,357.60	89.40	98.61%
SOCIAL SECURITY	101-1102-411-44-02	3,361.00	3,234.84	126.16	96.25%
RETIREMENT	101-1102-411-44-04	7,715.00	7,697.84	17.16	99.78%
WORKERS COMPENSATION	101-1102-411-44-06	497.00	495.27	1.73	99.65%
DATA PROCESSING TRAINING	101-1102-411-58-06	5,000.00		5,000.00	0.00%
COMPUTER EQUIP/SERVERS	101-1102-411-66-13	40,000.00	26,588.08	13,411.92	66.47%
SECURITY/SLED-DSS	101-1102-411-66-15	20,000.00	7,204.82	12,795.18	36.02%
SOFTWARE/LICENSES	101-1102-411-66-16	10,000.00	8,400.00	1,600.00	84.00%
NETWORK EQUIP/UPGRADE	101-1102-411-66-17	30,000.00	28,562.03	1,437.97	95.21%
		166,952.00	132,377.94	34,574.06	79.29%
DEVELOPMENT BOARD					
SALARIES	101-1103-411-11-50	144,254.00	144,067.71	186.29	99.87%
INSURANCE	101-1103-411-44-01	12,894.00	12,715.20	178.80	98.61%
SOCIAL SECURITY	101-1103-411-44-02	11,036.00	10,746.04	289.96	97.37%
RETIREMENT	101-1103-411-44-04	25,331.00	25,298.44	32.56	99.87%
WORKERS COMPENSATION	101-1103-411-44-06	3,967.00	3,961.97	5.03	99.87%
PROFESSIONAL SERVICES	101-1103-411-47-02	15,000.00	14,661.58	338.42	97.74%
MEMBERSHIPS & SUBSCRIPTIONS	101-1103-411-50-10	16,000.00	15,850.00	150.00	99.06%
TRAINING & TRAVEL	101-1103-411-58-05	13,600.00	13,216.02	383.98	97.18%
PRINTING & OFFICE SUPPLIES	101-1103-411-61-01	4,000.00	3,625.11	374.89	90.63%
VEHICLE OPERATION & MAINTENANCE	101-1103-411-65-01	1,000.00	307.06	692.94	30.71%
CAPITAL EXPENDITURES	101-1103-411-66-01	9,400.00	5,261.75	4,138.25	55.98%
LEASE & MAINTENANCE	101-1103-411-66-04	5,000.00	2,078.54	2,921.46	41.57%
INDUSTRIAL PARKS	101-1103-411-67-01	40,000.00	35,531.00	4,469.00	88.83%
MARKETING	101-1103-411-67-02	20,000.00	12,146.79	7,853.21	60.73%
GRANT EXPENDITURES	101-1103-411-67-03	2,000.00	1,959.93	40.07	98.00%
OPERATIONAL CONTINGENCY FUND	101-1103-411-75-02	2,000.00		2,000.00	0.00%
		325,482.00	301,427.14	24,054.86	92.61%
COMMUNITY DEVELOPMENT					
SALARIES	101-1104-411-11-50	61,173.00	50,605.35	567.65	99.07%
INSURANCE	101-1104-411-44-01	6,447.00	6,357.60	89.40	98.61%
SOCIAL SECURITY	101-1104-411-44-02	4,680.00	4,490.04	189.96	95.94%
RETIREMENT	101-1104-411-44-04	10,742.00	10,642.26	99.74	99.07%
WORKERS COMPENSATION	101-1104-411-44-06	1,683.00	1,666.74	16.26	99.03%
DUES, MEMBERSHIPS	101-1104-411-50-10	35.00	35.00	-	100.00%
TRAINING & TRAVEL	101-1104-411-58-06	3,500.00	3,470.34	29.66	99.15%
PRINTING & OFFICE SUPPLIES	101-1104-411-61-01	1,130.00	838.17	291.83	74.17%
MARKETING	101-1104-411-67-02	170.00	-	170.00	0.00%
OPERATIONAL CONTINGENCY FUND	101-1104-411-75-02	500.00	-	500.00	0.00%
		90,060.00	88,105.50	1,954.50	97.83%
TOURISM					
SALARIES	101-1105-411-11-50	46,618.00	48,306.36	(1,688.36)	103.62%
INSURANCE	101-1105-411-44-01	12,632.00	12,741.60	(109.60)	100.87%
SOCIAL SECURITY	101-1105-411-44-02	3,567.00	3,386.55	180.45	94.94%
RETIREMENT	101-1105-411-44-04	8,187.00	8,482.58	(295.58)	103.61%
WORKERS COMPENSATION	101-1105-411-44-06	1,282.00	1,312.42	(30.42)	102.37%
MEMBERSHIPS & SUBSCRIPTIONS	101-1105-411-50-25	2,000.00	700.00	1,300.00	35.00%
COMMUNICATIONS	101-1105-411-53-01	3,042.00	2,502.34	539.66	82.26%
ADVERTISING	101-1105-411-54-01	2,000.00	-	2,000.00	0.00%
TRAINING & TRAVEL	101-1105-411-58-06	6,500.00	5,553.77	946.23	85.44%
PRINTING & OFFICE SUPPLIES	101-1105-411-61-01	1,500.00	1,203.03	296.97	80.20%
POSTAGE	101-1105-411-61-01	55.00	-	55.00	0.00%
OPERATIONAL CONTINGENCY FUND	101-1105-411-75-02	2,500.00	77.04	2,422.96	3.08%
VISITOR CENTER	101-1105-411-75-11	-	-	-	#DIV/0!
EVENTS	101-1105-411-75-02	98,500.00	84,102.20	14,397.80	85.38%
WEB HOSTING	101-1105-411-75-12	-	-	-	#DIV/0!
		188,383.00	168,367.89	20,015.11	89.38%

UNION COUNTY SC
BUDGET TO ACTUAL VARIANCE

		2022-2023 BUDGET	PERIOD 13 FY 2023 ACTUAL	VARIANCE	%-AGE OF BUDGET
FIRE SERVICE					
SALARIES	101-1106-411-11-50	55,000.00	-	55,000.00	0.00%
INSURANCE	101-1106-411-44-01	-	-	-	#DIV/0!
SOCIAL SECURITY	101-1106-411-44-02	4,208.00	-	4,208.00	0.00%
RETIREMENT	101-1106-411-44-04	9,658.00	-	9,658.00	0.00%
WORKERS COMPENSATION	101-1106-411-44-06	3,223.00	-	3,223.00	0.00%
PROFESSIONAL SERVICES	101-1106-411-47-02	2,500.00	-	2,500.00	0.00%
UNIFORMS/SAFETY EQUIPMENT	101-1106-411-50-01	4,000.00	829.25	3,170.75	20.73%
DUES	101-1106-411-50-02	500.00	-	500.00	0.00%
TRAVEL	101-1106-411-58-01	500.00	-	500.00	0.00%
TRAINING	101-1106-411-58-02	2,500.00	77.22	2,422.78	3.09%
PRINTING & OFFICE SUPPLIES	101-1106-411-61-01	1,100.00	-	1,100.00	0.00%
SPECIALIZED DEPARTMENTAL SUPPLIES	101-1106-411-61-02	1,100.00	-	1,100.00	0.00%
POSTAGE	101-1106-411-61-06	200.00	-	200.00	0.00%
		84,489.00	906.47	83,582.53	1.07%
MAGISTRATE					
SALARIES	101-1201-412-11-50	229,170.00	230,775.00	(1,605.00)	100.70%
SALARIES - SECURITY	101-1201-412-11-61	25,990.00	24,211.00	1,779.00	93.16%
INSURANCE	101-1201-412-44-01	54,359.00	60,345.09	(5,986.09)	111.01%
SOCIAL SECURITY	101-1201-412-44-02	19,520.00	18,168.18	1,351.82	93.07%
RETIREMENT	101-1201-412-44-04	48,063.00	47,665.59	397.41	99.17%
WORKERS COMPENSATION	101-1201-412-44-06	6,610.00	6,015.65	594.35	91.01%
MEMBERSHIPS & SUBSCRIPTIONS	101-1201-412-50-25	789.00	788.90	0.10	99.99%
JURY PAY	101-1201-412-54-10	14,395.00	14,395.90	(0.90)	100.01%
APPEALS	101-1201-412-54-15	301.00	300.76	0.24	99.92%
TRAINING & TRAVEL	101-1201-412-58-06	8,560.00	8,392.50	167.50	98.04%
PRINTING & OFFICE SUPPLIES	101-1201-412-61-01	6,750.00	6,115.67	634.33	90.60%
JAIL OFFICE SUPPLIES	101-1201-412-61-02	1,155.00	1,157.81	(2.81)	100.24%
		415,662.00	418,332.05	(2,670.05)	100.64%
PROBATE JUDGE					
SALARIES	101-1202-412-11-50	99,721.00	92,009.80	7,711.20	92.27%
INSURANCE	101-1202-412-44-01	19,340.00	15,351.31	3,978.69	79.43%
SOCIAL SECURITY	101-1202-412-44-02	7,629.00	7,856.62	(227.62)	102.98%
RETIREMENT	101-1202-412-44-04	18,976.00	20,133.36	(1,157.36)	106.10%
WORKERS COMPENSATION	101-1202-412-44-06	1,644.00	331.53	1,312.47	20.17%
TRAINING	101-1202-412-58-05	2,585.00	1,524.72	1,060.28	58.98%
PRINTING & OFFICE SUPPLIES	101-1202-412-61-01	3,140.00	2,125.86	1,014.14	67.70%
CAPITAL EXPENDITURES	101-1202-412-66-01	-	-	-	#DIV/0!
		153,035.00	139,343.20	13,691.80	91.05%
CIRCUIT COURT					
SALARIES	101-1203-412-11-50	59,001.00	50,063.33	8,937.67	84.85%
SOCIAL SECURITY	101-1203-412-44-02	4,514.00	3,829.83	684.17	84.84%
RETIREMENT	101-1203-412-44-04	10,361.00	8,791.13	1,569.87	84.85%
WORKERS COMPENSATION	101-1203-412-44-06	2,042.00	1,639.57	402.43	80.29%
MISCELLANEOUS	101-1203-412-75-05	57,000.00	26,295.18	30,704.82	46.13%
		132,918.00	90,619.04	42,298.96	68.18%
PUBLIC DEFENDER					
MISCELLANEOUS	101-1204-412-75-05	168,813.00	168,813.00	-	100.00%
		168,813.00	168,813.00	-	100.00%
SOLICITOR'S OFFICE					
SALARIES	101-1205-412-11-50	423,864.00	411,688.18	12,175.82	97.13%
INSURANCE	101-1205-412-44-01	51,607.00	41,241.16	10,365.84	79.91%
SOCIAL SECURITY	101-1205-412-44-02	32,426.00	30,498.06	1,927.94	94.05%
RETIREMENT	101-1205-412-44-04	75,811.00	73,154.17	2,646.83	96.51%
WORKERS COMPENSATION	101-1205-412-44-06	3,160.00	2,528.26	631.74	80.01%
SERVICE CONTRACTS	101-1205-412-47-08	1,000.00	852.78	147.22	85.28%
TRAVEL	101-1205-412-58-01	1,000.00	996.29	3.71	99.63%
TRAINING	101-1205-412-58-05	900.00	691.77	208.23	76.86%
PRINTING & OFFICE SUPPLIES	101-1205-412-61-01	2,500.00	2,404.27	95.73	96.17%
		592,268.00	564,064.94	28,203.06	95.24%

UNION COUNTY SC
BUDGET TO ACTUAL VARIANCE

		2022-2023 BUDGET	PERIOD 13 FY 2023 ACTUAL	VARIANCE	%-AGE OF BUDGET
CLERK OF COURT					
SALARIES	101-1220-412-11-50	308,958.00	326,547.80	(17,589.80)	105.69%
SALARIES - TITLE IV-D LARGE	101-1220-412-11-60	27,179.00	-	27,179.00	0.00%
SALARIES - TITLE IV-D SMALL	101-1220-412-11-66	14,300.00	18,390.63	(4,090.63)	128.61%
INSURANCE	101-1220-412-44-01	83,578.00	70,128.45	13,449.55	83.91%
SOCIAL SECURITY	101-1220-412-44-02	26,829.00	26,107.04	721.96	97.31%
RETIREMENT	101-1220-412-44-04	61,537.00	63,198.88	(1,661.88)	102.70%
WORKERS COMPENSATION	101-1220-412-44-06	1,087.00	3,064.45	(1,977.45)	281.92%
MEMBERSHIPS & SUBSCRIPTIONS	101-1220-412-50-25	300.00	300.00	-	100.00%
TRAINING	101-1220-412-58-05	3,000.00	1,672.67	1,327.33	55.76%
PRINTING & OFFICE SUPPLIES	101-1220-412-61-01	7,750.00	6,615.00	1,134.00	85.37%
BOOK IMPROVEMENTS (RESTORATION)	101-1220-412-61-05	10,000.00	10,000.00	-	100.00%
		544,518.00	526,025.92	18,492.08	96.60%
VOTER REGISTRATION/ELECTION COMM					
SALARIES	101-1401-414-11-50	74,825.00	73,705.57	1,119.43	98.50%
SALARIES - POLLWORKERS	101-1401-414-11-62	75,000.00	37,327.50	37,672.50	49.77%
INSURANCE	101-1401-414-44-01	15,941.00	16,103.04	(162.04)	101.02%
SOCIAL SECURITY	101-1401-414-44-02	5,725.00	5,546.92	178.08	96.89%
RETIREMENT	101-1401-414-44-04	13,239.00	14,553.28	(1,314.28)	109.93%
WORKERS COMPENSATION	101-1401-414-44-06	465.00	410.43	54.57	88.26%
MAINTENANCE CONTRACTS	101-1401-414-47-01	300.00	252.45	47.55	84.15%
DUES	101-1401-414-50-02	450.00	400.00	50.00	88.89%
TRAVEL	101-1401-414-58-01	1,200.00	(219.81)	1,419.81	-18.32%
TRAINING	101-1401-414-58-05	900.00	300.00	600.00	33.33%
PRINTING & OFFICE SUPPLIES	101-1401-414-61-01	7,075.00	5,282.80	1,792.20	74.67%
MACHINERY & EQUIPMENT REPAIR	101-1401-414-65-02	1,700.00	-	1,700.00	0.00%
		195,820.00	153,662.18	43,157.82	78.07%
COUNTY ATTORNEY					
SALARIES	101-1501-415-11-50	29,555.00	29,523.94	31.06	99.89%
SOCIAL SECURITY	101-1501-415-44-02	2,261.00	2,258.60	2.40	99.89%
RETIREMENT	101-1501-415-44-04	5,190.00	5,184.20	5.80	99.89%
WORKERS COMPENSATION	101-1501-415-44-06	110.00	109.10	0.90	99.18%
TRAINING	101-1501-415-58-05	250.00	-	250.00	0.00%
		37,366.00	37,075.84	290.16	99.22%
BUILDING INSPECTOR					
SALARIES	101-1505-415-11-50	17,597.00	17,596.81	0.19	100.00%
INSURANCE	101-1505-415-44-01	61.00	60.06	0.94	98.46%
SOCIAL SECURITY	101-1505-415-44-02	1,317.00	1,316.28	0.72	99.95%
RETIREMENT	101-1505-415-44-04	3,090.00	3,089.99	0.01	100.00%
WORKERS COMPENSATION	101-1505-415-44-06	522.00	521.69	0.31	99.94%
PROFESSIONAL SERVICES	101-1505-415-47-02	74,007.00	131,400.87	(57,393.87)	177.55%
UNIFORMS	101-1505-415-50-01	-	-	-	NDIV/OI
DEMOLITION - CONDEMNATION	101-1505-415-54-60	20,000.00	8,930.00	11,070.00	44.65%
PROPERTY IMPROVEMENTS	101-1505-415-54-70	6,000.00	3,150.00	2,850.00	52.50%
TRAINING	101-1505-415-58-05	-	-	-	NDIV/OI
PRINTING & OFFICE SUPPLIES	101-1505-415-61-01	2,000.00	156.22	1,843.78	7.81%
		124,594.00	166,221.92	(41,627.92)	133.41%
TAX ASSESSOR					
SALARIES	101-1510-415-11-50	136,218.00	135,654.90	563.10	99.59%
INSURANCE	101-1510-415-44-01	28,834.00	28,793.88	40.12	99.86%
SOCIAL SECURITY	101-1510-415-44-02	10,421.00	9,704.03	716.97	93.12%
RETIREMENT	101-1510-415-44-04	23,920.00	23,820.93	99.07	99.59%
WORKERS COMPENSATION	101-1510-415-44-06	2,599.00	2,594.36	4.64	99.82%
PROFESSIONAL SERVICES	101-1510-415-47-02	20,556.00	18,199.05	2,356.95	88.53%
DUES	101-1510-415-50-02	925.00	295.00	630.00	31.89%
TRAINING	101-1510-415-58-05	2,000.00	874.14	1,125.86	43.71%
PRINTING & OFFICE SUPPLIES	101-1510-415-61-01	1,000.00	784.20	215.80	78.42%
SPECIALIZED DEPARTMENTAL SUPPLIES	101-1510-415-61-02	500.00	429.00	71.00	85.80%
		226,973.00	221,149.49	5,823.51	97.43%
DELINQUENT TAX OFFICE					
SALARIES	101-1511-415-11-50	70,684.00	73,106.06	(2,422.06)	103.43%
INSURANCE	101-1511-415-44-01	6,447.00	6,357.60	89.40	98.61%
SOCIAL SECURITY	101-1511-415-44-02	5,408.00	5,592.54	(184.54)	103.41%
RETIREMENT	101-1511-415-44-04	12,413.00	12,837.40	(424.40)	103.42%
WORKERS COMPENSATION	101-1511-415-44-06	220.00	226.68	(6.68)	103.04%
MEMBERSHIPS & SUBSCRIPTIONS	101-1511-415-50-25	125.00	75.00	50.00	60.00%
TRAINING	101-1511-415-58-05	2,200.00	2,191.57	8.43	99.62%
PRINTING & OFFICE SUPPLIES	101-1511-415-61-01	600.00	278.66	321.34	46.44%
		98,097.00	100,665.51	(2,568.51)	102.62%

UNION COUNTY SC
BUDGET TO ACTUAL VARIANCE

		2022-2023	PERIOD 13 FY 2023	VARIANCE	%-AGE OF
		BUDGET	ACTUAL		BUDGET
TREASURER'S OFFICE					
SALARIES	101-1520-415-11-50	137,580.00	134,854.17	2,725.83	98.02%
INSURANCE	101-1520-415-44-01	12,894.00	15,381.71	(2,487.71)	119.29%
SOCIAL SECURITY	101-1520-415-44-02	10,525.00	9,948.60	576.40	94.52%
RETIREMENT	101-1520-415-44-04	24,160.00	23,680.36	479.64	98.01%
WORKERS COMPENSATION	101-1520-415-44-06	427.00	417.93	9.07	97.88%
MEMBERSHIPS & SUBSCRIPTIONS	101-1520-415-50-25	80.00	75.00	5.00	93.75%
ADVERTISING	101-1520-415-54-01	675.00	633.00	42.00	93.78%
TRAINING	101-1520-415-58-05	2,500.00	2,188.18	311.82	87.53%
PRINTING & OFFICE SUPPLIES	101-1520-415-61-01	3,300.00	1,017.01	2,282.99	30.82%
		192,141.00	188,195.96	3,945.04	97.95%
AUDITOR'S OFFICE					
SALARIES	101-1525-415-11-50	115,334.00	115,182.61	151.39	99.87%
INSURANCE	101-1525-415-44-01	22,387.00	22,436.28	(49.28)	100.22%
SOCIAL SECURITY	101-1525-415-44-02	8,823.00	8,329.41	493.59	94.41%
RETIREMENT	101-1525-415-44-04	20,253.00	20,226.01	26.99	99.87%
WORKERS COMPENSATION	101-1525-415-44-06	358.00	1,673.48	(1,315.48)	467.45%
MEMBERSHIPS & SUBSCRIPTIONS	101-1525-415-50-25	150.00	125.00	25.00	83.33%
TRAINING	101-1525-415-58-05	3,000.00	3,000.00	-	100.00%
PRINTING & OFFICE SUPPLIES	101-1525-415-61-01	1,600.00	542.29	1,057.71	33.89%
		171,905.00	171,515.08	389.92	99.77%
BUILDING SUPERINTENDENT					
SALARIES	101-1910-419-11-50	67,529.00	69,747.27	(2,218.27)	103.28%
INSURANCE	101-1910-419-44-01	6,447.00	6,517.93	(70.93)	101.10%
SOCIAL SECURITY	101-1910-419-44-02	5,166.00	5,435.66	(269.66)	105.22%
RETIREMENT	101-1910-419-44-04	11,858.00	12,957.56	(1,099.56)	109.27%
WORKERS COMPENSATION	101-1910-419-44-06	3,114.00	3,197.16	(83.16)	102.67%
BUILDING EXPENSE	101-1910-419-60-10	110,000.00	102,722.34	7,277.66	93.38%
GENERAL SUPPLIES	101-1910-419-61-01			-	#DIV/0!
CAPITAL EXPEND - HVAC & EQUIP	101-1910-419-66-01			-	#DIV/0!
		204,114.00	200,577.92	3,536.08	98.27%

UNION COUNTY SC
BUDGET TO ACTUAL VARIANCE

		2022-2023	PERIOD 13		
		BUDGET	FY 2023	VARIANCE	%-AGE OF
			ACTUAL		BUDGET
NON-DEPARTMENTAL					
PERSONNEL SUPPLEMENT	101-1990-419-11-50	8,000.00	4,695.05	3,304.95	58.69%
UTILITIES	101-1990-419-40-01	414,000.00	341,420.86	72,579.14	82.47%
EMPLOYEE INSURANCE	101-1990-419-44-01	30,420.00	43,647.62	(13,227.62)	143.48%
SOCIAL SECURITY	101-1990-419-44-02	3,000.00	-	3,000.00	0.00%
RETIREMENT	101-1990-419-44-04	3,500.00	160.22	3,339.78	4.58%
WORKERS COMPENSATION	101-1990-419-44-06	50,000.00	(4,453.00)	54,453.00	-8.91%
UNEMPLOYMENT	101-1990-419-44-07	20,000.00	-	20,000.00	0.00%
ACCRUALS	101-1990-419-44-08	30,000.00	-	30,000.00	0.00%
PARKING LOTS	101-1990-419-46-02	1,500.00	1,500.00	-	100.00%
RENTAL FEES	101-1990-419-46-04	-	5,400.00	(5,400.00)	#DIV/0!
MAINTENANCE CONTRACTS	101-1990-419-47-01	145,000.00	68,120.77	76,879.23	46.98%
PROFESSIONAL SERVICES	101-1990-419-47-02	390,000.00	386,288.49	3,711.51	99.05%
COMPUTER SVCS & SUPPLIES (QS-3)	101-1990-419-47-04	180,436.00	156,383.04	24,052.96	86.67%
GIS/CAS ZUERCHER (20%)	101-1990-419-47-07	8,000.00	-	-	-
AUDIT COUNTY BOOKS	101-1990-419-47-06	65,000.00	62,500.00	2,500.00	96.15%
OPEB	101-1990-419-47-10	12,000.00	10,500.00	1,500.00	87.50%
GENERAL INSURANCE	101-1990-419-52-01	556,000.00	527,638.10	28,361.90	94.90%
COMMUNICATIONS	101-1990-419-53-01	240,000.00	213,724.99	26,275.01	89.05%
ADVERTISING	101-1990-419-54-01	15,000.00	14,382.68	617.32	95.88%
VOLUNTEER FIREMAN'S INSURANCE	101-1990-419-54-25	18,081.00	16,649.00	1,432.00	92.08%
GENERAL ELECTION EXPENSE	101-1990-419-54-30	8,000.00	3,602.98	4,397.02	45.04%
HOSPITAL INDIGENT CARE	101-1990-419-54-35	37,561.00	29,208.00	8,353.00	77.76%
INDIGENT DEFENSE FUND SUPPLEMENT	101-1990-419-54-36	-	-	-	-
PRINTING & OFFICE SUPPLIES	101-1990-419-61-01	-	(668.14)	668.14	#DIV/0!
POSTAGE METER RENT & POSTAGE	101-1990-419-61-06	65,000.00	48,760.40	16,239.60	75.02%
FUEL COSTS	101-1990-419-65-11	385,000.00	323,114.98	61,885.02	83.93%
CAPITAL EXPENDITURES	101-1990-419-66-01	780,733.00	477,502.81	303,230.19	61.16%
LEASES & COPIES	101-1990-419-66-03	65,000.00	56,400.40	8,599.60	86.77%
CONTINGENCY FUND	101-1990-419-75-01	63,274.00	35.00	63,239.00	0.06%
OPERATIONAL CONTINGENCY	101-1990-419-75-02	100,000.00	52,240.11	47,759.89	52.24%
ED CONTINGENCY/GRANTS ADM	101-1990-419-75-03	50,000.00	23,316.86	26,683.14	46.63%
AUCTION FEES	101-1990-419-75-16	500.00	13,442.55	(12,942.55)	2688.51%
INSURED REPAIRS	101-1990-419-75-17	-	36,958.11	(36,958.11)	#DIV/0!
REIMB XMAS DONATIONS	101-1990-419-75-22	-	208.63	(208.63)	#DIV/0!
BUFFALO FIREWORKS DONATION	101-1990-419-75-24	-	-	-	#DIV/0!
CONTINGENCY-SPECIAL SO	101-1990-419-75-28	-	-	-	#DIV/0!
LANDFILL CONTRIBUTION-CKFD	101-1990-419-75-29	-	31,250.00	(31,250.00)	#DIV/0!
OFFICAL ALLOWANCE	101-1990-419-75-31	9,600.00	9,200.00	400.00	95.83%
ANNUAL INCENTIVE AWARD	101-1990-419-75-32	13,000.00	11,425.00	1,575.00	87.88%
4TH OF JULY CELEBRATIONS	101-1990-419-75-33	-	-	-	-
CATAWBA REGIONAL COG	101-1990-419-80-02	37,654.00	37,654.00	-	100.00%
CLEMSON EXT	101-1990-419-80-03	9,000.00	5,231.73	3,768.27	58.13%
CLEMSON EXT - 4H AGENT	101-1990-419-80-04	12,000.00	12,000.00	-	100.00%
SC ASSOC OF COUNTIES	101-1990-419-80-07	8,390.00	8,389.19	0.81	99.99%
SOIL & WATER CONSERVATION	101-1990-419-80-11	3,500.00	3,500.00	-	100.00%
FIRE & RESCUE	101-1990-419-80-12	50,000.00	50,000.00	-	100.00%
MENTAL HEALTH	101-1990-419-80-13	-	-	-	-
UNION CTY MUSEUM/CROSS KEYS HOUSE	101-1990-419-80-18	45,000.00	45,000.00	-	100.00%
UNION CTY CHAMBER OF COMMERCE	101-1990-419-80-20	25,000.00	18,750.00	6,250.00	75.00%
POST-CLOSURE LANDFILL COSTS	101-1990-419-80-21	40,000.00	31,894.00	8,106.00	79.74%
SATELLITE LIBRARY CENTERS (CENSUS)	101-1990-419-80-23	15,000.00	-	15,000.00	0.00%
TUITION ASSISTANCE	101-1990-419-80-24	150,000.00	65,753.00	84,247.00	43.84%
CRIME STOPPERS	101-1990-419-80-25	2,000.00	2,000.00	-	100.00%
C-4	101-1990-419-80-26	25,000.00	25,000.00	-	100.00%
SALARY ADJUSTMENTS	101-1990-419-80-50	-	-	-	-
TRANSFER OUT	101-1990-599-99-99	57,000.00	57,000.00	-	100.00%
		4,247,149.00	3,326,727.43	912,421.57	78.33%

UNION COUNTY SC
BUDGET TO ACTUAL VARIANCE

		2022-2023 BUDGET	PERIOD 13 FY 2023 ACTUAL	VARIANCE	%-AGE OF BUDGET
SHERIFF'S OFFICE					
SALARIES	101-2101-421-11-50	1,721,443.00	1,605,442.34	116,000.66	93.26%
SCHOOL RESOURCE OFFICER	101-2101-421-11-52	292,843.00	279,860.56	12,982.44	95.57%
RESERVE DEPUTY PROGRAM	101-2101-421-11-53	28,385.00	5,046.85	23,338.15	17.78%
INSURANCE	101-2101-421-44-01	319,516.00	304,180.20	15,335.80	95.20%
SOCIAL SECURITY	101-2101-421-44-02	156,265.00	140,409.43	15,855.57	89.85%
RETIREMENT	101-2101-421-44-04	405,314.00	382,219.38	23,094.62	94.30%
WORKERS COMPENSATION	101-2101-421-44-06	67,883.00	59,516.76	8,366.24	87.68%
MAINTENANCE-ZUERCHER	101-2101-421-47-01	18,000.00	17,306.58	693.42	96.15%
CLOTHING & UNIFORMS	101-2101-421-50-01	16,000.00	15,947.59	52.41	99.67%
DUES SCLEOA & SHERIFFS' ASSOC	101-2101-421-50-03	3,500.00	2,085.80	1,414.20	59.59%
ADVERTISING	101-2101-421-54-01	5,000.00	4,861.46	138.54	97.23%
TRAINING	101-2101-421-58-05	11,200.00	11,174.19	25.81	99.77%
PRINTING & OFFICE SUPPLIES	101-2101-421-61-01	11,900.00	11,746.90	153.10	98.71%
INVESTIGATIVE SUPPLIES	101-2101-421-61-03	7,500.00	6,551.12	948.88	87.35%
K9 TRAINING/SUPPLIES	101-2101-421-61-05	15,625.00	7,719.69	7,905.31	49.41%
SRT EQUIPMENT/TRAINING	101-2101-421-61-06	12,470.00	12,094.52	375.48	96.99%
WEAPONS/AMMO	101-2101-421-61-11	10,000.00	6,964.09	3,035.91	69.64%
EVIDENCE CUSTODIAN SUPPLIES	101-2101-421-61-12	3,900.00	2,802.72	1,097.28	71.86%
NARCOTICS SUPPLIES	101-2101-421-61-13	13,500.00	5,933.75	7,566.25	43.63%
INFORMANT MONEY	101-2101-421-62-01	15,000.00	7,500.00	7,500.00	50.00%
STATE 800 RADIO SERVICES	101-2101-421-66-11	19,000.00	16,497.48	2,502.52	86.83%
MOBILE ROUTER RENEWAL FEES	101-2101-421-66-51	8,400.00	3,593.11	4,806.89	47.54%
		3,162,744.00	2,909,854.52	252,889.48	#DIV/0! 92.00%
CODE ENFORCEMENT					
SALARIES	101-2105-421-11-50	142,525.00	131,795.71	10,729.29	92.47%
INSURANCE	101-2105-421-44-01	22,773.00	16,367.46	6,405.54	71.87%
SOCIAL SECURITY	101-2105-421-44-02	10,904.00	9,728.26	1,175.74	89.22%
RETIREMENT	101-2105-421-44-04	27,810.00	24,640.67	3,169.33	88.60%
WORKERS COMPENSATION	101-2105-421-44-06	4,932.00	4,389.14	542.86	88.99%
CLOTHING & UNIFORMS	101-2105-421-50-01	1,500.00	567.49	932.51	37.83%
SPECIALIZED DEPARTMENTAL SUPPLIES	101-2105-421-61-02	7,000.00	6,831.21	168.79	97.59%
		217,444.00	194,319.94	23,124.06	89.37%
ANIMAL CONTROL					
SALARIES	101-2110-421-11-50	68,865.00	69,459.65	(594.65)	100.86%
INSURANCE	101-2110-421-44-01	16,327.00	16,367.46	(40.46)	100.25%
SOCIAL SECURITY	101-2110-421-44-02	5,269.00	4,897.99	371.01	92.96%
RETIREMENT	101-2110-421-44-04	13,133.00	12,197.07	935.93	92.87%
WORKERS COMPENSATION	101-2110-421-44-06	2,065.00	2,003.07	61.93	97.00%
MAINTENANCE CONTRACTS	101-2110-421-47-01			-	#DIV/0!
CLOTHING & UNIFORMS	101-2110-421-50-01	1,300.00	951.37	348.63	73.18%
TRAINING	101-2110-421-58-05	500.00		500.00	0.00%
SPECIALIZED DEPARTMENTAL SUPPLIES	101-2110-421-61-02	32,459.00	32,434.56	24.44	99.92%
CHEMICALS	101-2110-421-61-10	2,000.00	1,168.85	831.15	58.44%
FOOD ALLOWANCE FOR ANIMALS	101-2110-421-63-03	4,500.00	1,980.71	2,519.29	44.02%
TRAPS & CAPTURING EQUIP	101-2110-421-66-12	3,488.00	864.77	2,623.23	24.79%
CAT LIVING PENS	101-2110-421-66-13	-		-	#DIV/0!
COMMUNITY AIDE	101-2110-421-66-14	2,000.00	1,337.83	662.17	66.89%
		151,906.00	143,663.33	8,242.67	94.57%
CORONER					
SALARIES	101-2190-421-11-50	43,013.00	49,345.63	(6,332.63)	114.72%
INSURANCE	101-2190-421-44-01	12,632.00	12,741.63	(109.63)	100.87%
SOCIAL SECURITY	101-2190-421-44-02	3,291.00	3,576.25	(285.25)	108.67%
RETIREMENT	101-2190-421-44-04	8,061.00	9,901.20	(1,840.20)	122.83%
WORKERS COMPENSATION	101-2190-421-44-06	1,489.00	1,761.91	(272.91)	118.33%
PROFESSIONAL SERVICES	101-2190-421-47-02	85,000.00	62,347.25	22,652.75	73.35%
DUES	101-2190-421-50-12	350.00	200.00	150.00	57.14%
TRAVEL	101-2190-421-58-01	2,400.00	2,400.00	-	100.00%
TRAINING	101-2190-421-58-05	2,500.00	1,775.52	723.48	71.06%
PRINTING & OFFICE SUPPLIES	101-2190-421-61-01	400.00	135.94	264.06	33.99%
SPECIALIZED DEPARTMENTAL SUPPLIES	101-2190-421-61-02	6,000.00	1,202.76	4,797.24	20.05%
		165,136.00	145,389.09	19,746.91	88.04%

UNION COUNTY SC
BUDGET TO ACTUAL VARIANCE

		2022-2023 BUDGET	PERIOD 13 FY 2023 ACTUAL	VARIANCE	%-AGE OF BUDGET
DETENTION CENTER					
SALARIES	101-2320-423-11-50	1,605,678.00	1,542,033.43	63,644.57	96.04%
INSURANCE	101-2320-423-44-01	263,365.00	246,142.54	17,222.46	93.46%
SOCIAL SECURITY	101-2320-423-44-02	122,835.00	112,721.23	10,113.77	91.77%
RETIREMENT	101-2320-423-44-04	324,703.00	312,086.07	12,616.93	96.11%
WORKERS COMPENSATION	101-2320-423-44-06	56,285.00	47,321.90	8,963.10	84.08%
MAINTENANCE CONTRACTS	101-2320-423-47-01	12,998.00	12,335.52	662.48	94.90%
PROFESSIONAL SERVICES	101-2320-423-47-02	48,623.00	46,666.14	1,956.86	95.98%
HEALTH CARE CONTRACT	101-2320-423-47-10	174,650.00	171,360.56	3,289.44	98.12%
CLOTHING & UNIFORMS	101-2320-423-50-01	11,735.00	11,734.96	0.04	100.00%
COMMUNICATIONS	101-2320-423-53-01	2,030.00	2,030.00	-	100.00%
TRAINING	101-2320-423-58-05	4,311.00	4,310.07	0.93	99.98%
OPERATING EXPENSE	101-2320-423-60-15	20,320.00	20,299.60	20.40	99.90%
PRINTING & OFFICE SUPPLIES	101-2320-423-61-01	3,678.00	3,677.35	0.65	99.98%
SPECIALIZED DEPARTMENTAL SUPPLIES	101-2320-423-61-02	26,065.00	25,490.18	574.82	97.79%
CHEMICALS	101-2320-423-61-10	8,379.00	8,378.68	0.32	100.00%
JUVENILE DETENTION	101-2320-423-62-10	25,000.00	5,100.00	19,900.00	20.40%
DIETING PRISONERS	101-2320-423-63-01	179,348.00	191,441.61	(12,093.61)	106.74%
PRISONER TRANSPORT, MEALS	101-2320-423-63-02	2,000.00	1,433.05	566.95	71.65%
SUBSISTENCE CARE	101-2320-423-63-03	26,706.00	25,922.81	783.19	97.07%
CAPITAL EXPENDITURES	101-2320-423-66-01	-	-	-	#DIV/0!
		2,918,709.00	2,790,485.70	128,223.30	95.61%
E-911 & COMMUNICATIONS					
SALARIES	101-2901-429-11-50	570,179.00	466,292.57	103,886.43	81.78%
SALARIES - SUBSCRIBER BILLING	101-2901-429-11-55	50,115.00	57,708.78	(7,593.78)	115.15%
SALARIES - P/T DISPATCHERS	101-2901-429-11-63	20,000.00	33,135.13	(13,135.13)	165.68%
INSURANCE	101-2901-429-44-01	83,317.00	61,760.78	21,556.22	74.13%
SOCIAL SECURITY	101-2901-429-44-02	45,417.00	41,097.50	4,319.50	90.49%
RETIREMENT	101-2901-429-44-04	105,455.00	99,322.41	6,132.59	94.18%
WORKERS COMPENSATION	101-2901-429-44-06	1,779.00	1,498.74	280.26	84.25%
MAINTENANCE CONTRACTS	101-2901-429-47-01	193,833.00	106,198.65	27,634.35	75.35%
PROFESSIONAL SERVICES	101-2901-429-47-02	2,750.00	2,742.14	7.86	99.71%
RADIO MAINTENANCE	101-2901-429-47-03	12,615.00	30,555.29	(17,940.29)	242.21%
CLOTHING & UNIFORMS	101-2901-429-50-01	986.00	830.32	155.68	84.21%
MEMBERSHIPS & SUBSCRIPTIONS	101-2901-429-50-25	1,000.00	611.44	388.56	61.14%
COMMUNICATIONS	101-2901-429-53-01	12,616.00	11,695.90	920.10	92.71%
TRAINING	101-2901-429-58-01	5,000.00	4,201.23	798.77	84.02%
COMMUNICATON CTR OPER	101-2901-429-60-20	5,267.00	5,132.06	134.94	97.44%
PRINTING & OFFICE SUPPLIES	101-2901-429-61-01	952.00	860.43	91.57	90.38%
SPECIALIZED DEPARTMENTAL SUPPLIES	101-2901-429-61-02	2,136.00	1,365.39	770.61	63.92%
JANITORIAL SUPPLIES	101-2901-429-61-15	1,143.00	1,076.16	66.84	94.15%
TOWER RENTAL	101-2901-429-65-02	102,029.00	100,089.18	1,939.82	98.10%
		1,156,589.00	1,026,174.10	130,414.90	88.72%
EMERGENCY SERVICES					
SALARIES	101-2902-429-11-50	103,544.00	89,521.31	13,922.69	86.55%
INSURANCE	101-2902-429-44-01	6,447.00	15,762.09	(9,315.09)	244.49%
SOCIAL SECURITY	101-2902-429-44-02	7,922.00	6,546.55	1,375.45	82.64%
RETIREMENT	101-2902-429-44-04	20,014.00	16,409.74	3,604.26	81.99%
WORKERS COMPENSATION	101-2902-429-44-06	4,113.00	4,289.70	(176.70)	104.30%
UNIFORMS	101-2902-429-50-01	329.00	109.14	219.86	33.17%
DUES	101-2902-429-50-02	540.00	300.00	240.00	55.56%
MEMBERSHIPS & SUBSCRIPTIONS	101-2902-429-50-25	350.00	-	350.00	0.00%
COMMUNICATIONS	101-2902-429-53-01	14,676.00	13,596.45	1,079.55	92.64%
TRAINING	101-2902-429-58-05	1,660.00	1,591.85	68.15	95.89%
PRINTING & OFFICE SUPPLIES	101-2902-429-61-01	1,429.00	911.61	517.39	63.79%
SPECIALIZED DEPARTMENTAL SUPPLIES	101-2902-429-61-02	2,628.00	2,534.06	93.94	96.43%
		163,652.00	151,672.50	11,979.50	92.68%
COUNTY MAINTENANCE					
SALARIES	101-3101-431-11-50	267,040.00	253,768.41	13,271.59	95.03%
SALARIES-SUMMER MAINT WORKERS	101-3101-431-11-64	-	-	-	#DIV/0!
INSURANCE	101-3101-431-44-01	57,497.00	59,555.35	(2,058.35)	103.58%
SOCIAL SECURITY	101-3101-431-44-02	20,429.00	18,562.75	1,866.25	90.86%
RETIREMENT	101-3101-431-44-04	46,893.00	41,381.29	5,511.71	88.25%
WORKERS COMPENSATION	101-3101-431-44-06	18,271.00	17,060.42	1,210.58	93.37%
PROFESSIONAL SERVICES	101-3101-431-47-02	86,342.00	82,553.90	3,788.10	95.61%
UNIFORMS & CLOTHING	101-3101-431-50-01	4,500.00	3,727.31	772.69	82.83%
TRAINING	101-3101-431-58-01	3,500.00	963.28	2,536.72	27.52%
ROAD & BRIDGE	101-3101-431-59-01	105,000.00	93,737.00	11,263.00	89.27%
ROAD SIGNS	101-3101-429-59-02	14,500.00	10,965.95	3,534.05	75.63%
ASPHALT	101-3101-431-59-05	24,000.00	22,562.58	1,437.42	94.01%
CRUSHER RUN & GRAVEL	101-3101-431-59-10	25,000.00	24,996.07	3.93	99.98%
GENERAL SUPPLIES	101-3101-431-61-07	12,000.00	11,989.68	10.32	99.91%
		584,972.00	541,823.99	43,148.01	93.70%

UNION COUNTY SC
BUDGET TO ACTUAL VARIANCE

		2022-2023	PERIOD 13 FY 2023	VARIANCE	%-AGE OF BUDGET
		BUDGET	ACTUAL		
EQUIPMENT SHOP					
SALARIES	101-3102-431-11-50	87,591.00	88,797.87	(1,206.87)	101.38%
INSURANCE	101-3102-431-44-01	22,512.00	22,751.46	(239.46)	101.06%
SOCIAL SECURITY	101-3102-431-44-02	6,701.00	6,266.53	434.47	93.52%
RETIREMENT	101-3102-431-44-04	15,381.00	15,592.89	(211.89)	101.38%
WORKERS COMPENSATION	101-3102-431-44-06	4,073.00	4,065.82	7.18	99.82%
UNIFORMS & CLOTHING	101-3102-431-50-01	2,500.00	2,017.13	482.87	80.69%
TRAINING	101-3102-431-58-05	4,000.00	3,413.11	586.89	85.33%
SUPPLIES	101-3102-431-61-04	12,000.00	5,706.94	6,293.06	47.56%
VEHICLE MAINTENANCE & REPAIR	101-3102-431-65-01	162,000.00	153,537.16	8,462.84	94.78%
MACHINERY & EQUIPMENT REPAIR	101-3102-431-65-02	56,000.00	47,443.77	8,556.23	84.72%
TIRES	101-3102-431-65-10	55,000.00	55,000.57	(0.57)	100.00%
		427,758.00	404,593.25	23,164.75	94.58%
HEALTH DEPARTMENT					
MAINTENANCE CONTRACTS	101-4101-441-47-01	2,300.00		2,300.00	0.00%
SPECIAL CONTRACTS	101-4101-441-47-05	1,000.00		1,000.00	0.00%
BUILDING EXPENSES	101-4101-441-60-10	22,000.00	19,285.03	2,714.97	87.66%
CHEMICALS	101-4101-441-61-10	2,300.00	2,043.20	256.80	88.83%
MACHINERY & EQUIPMENT REPAIR	101-4101-441-65-02	1,000.00		1,000.00	0.00%
		28,600.00	21,328.23	7,271.77	74.57%
DEPARTMENT OF SOCIAL SERVICES					
UTILITIES	101-4110-441-40-01	40,000.00	34,317.00	5,683.00	85.79%
EMERGENCY RELIEF	101-4110-441-54-05	1,000.00	-	1,000.00	0.00%
PRINTING & OFFICE SUPPLIES	101-4110-441-61-01	1,000.00	-	1,000.00	0.00%
		42,000.00	34,317.00	7,683.00	81.71%
VETERAN'S AFFAIRS					
SALARIES	101-4120-441-11-50	55,730.00	55,003.04	726.96	98.70%
INSURANCE	101-4120-441-44-01	12,632.00	12,741.63	(109.63)	100.87%
SOCIAL SECURITY	101-4120-441-44-02	4,264.00	3,838.93	425.07	90.03%
RETIREMENT	101-4120-441-44-04	9,787.00	9,658.55	128.45	98.69%
WORKERS COMPENSATION	101-4120-441-44-06	173.00	1,267.71	(1,094.71)	732.78%
MEMBERSHIPS & SUBSCRIPTIONS	101-4120-441-50-25	200.00	170.80	29.20	85.40%
TRAINING	101-4120-441-58-05	2,437.00	2,023.75	413.25	83.04%
PRINTING & OFFICE SUPPLIES	101-4120-441-61-01	1,990.00	1,690.54	299.46	84.95%
CAPITAL EXPEND - CLIENT DATA BASE	101-4120-441-66-01	989.00	912.24	76.76	92.24%
		88,202.00	87,307.19	894.81	98.99%
ALCOHOL & DRUG ABUSE					
SALARIES	101-4150-441-11-50	368,304.00	315,534.89	52,769.11	85.67%
INSURANCE	101-4150-441-44-01	74,118.00	65,059.74	9,058.26	87.78%
SOCIAL SECURITY	101-4150-441-44-02	28,176.00	22,687.78	5,488.22	80.52%
RETIREMENT	101-4150-441-44-04	64,675.00	55,407.91	9,267.09	85.67%
WORKERS COMPENSATION	101-4150-441-44-06	2,540.00	3,075.95	(535.95)	121.10%
UTILITIES	101-4150-441-40-01	16,300.00	13,617.06	2,682.94	83.54%
PROFESSIONAL SERVICES	101-4150-441-47-02	52,000.00	51,986.38	13.62	99.97%
MEMBERSHIPS & SUBSCRIPTIONS	101-4150-441-50-25	15,000.00	14,416.60	583.40	96.11%
GENERAL INSURANCE	101-4150-441-52-01	9,500.00	1,985.40	7,514.60	20.90%
TRAINING	101-4150-441-58-05	12,600.00	7,686.80	4,913.20	61.01%
MAINTENANCE & UPKEEP	101-4150-441-60-30	1,500.00	1,350.00	150.00	90.00%
PRINTING & OFFICE SUPPLIES	101-4150-441-61-01	12,350.00	10,364.55	1,995.45	83.86%
SPECIALIZED DEPARTMENTAL SUPPLIES	101-4150-441-61-02	6,300.00	4,769.62	1,530.38	75.71%
POSTAGE EXPENSE	101-4150-441-61-06	500.00	-	500.00	0.00%
OTHER MISCELLANEOUS	101-4150-441-75-02	8,500.00	5,578.72	2,921.28	65.63%
		672,373.00	573,521.40	98,851.60	85.30%
VICTIM ADVOCATE					
SALARIES	101-4190-441-11-50	54,023.00	53,953.32	69.68	99.87%
INSURANCE	101-4190-441-44-01	6,447.00	6,357.60	89.40	98.61%
SOCIAL SECURITY	101-4190-441-44-02	4,133.00	3,947.74	185.26	95.52%
RETIREMENT	101-4190-441-44-04	9,490.00	9,474.16	15.84	99.83%
WORKERS COMPENSATION	101-4190-441-44-06	1,870.00	1,866.74	3.26	99.83%
MAINTENANCE CONTRACT-ZUERCHER	101-4190-441-47-01	1,000.00	982.66	17.34	98.27%
DUES	101-4190-441-50-02	30.00	30.00	-	100.00%
SPECIAL PROJECTS AWARENESS	101-4190-441-50-20	2,000.00	55.98	1,944.02	2.80%
COMMUNICATIONS	101-4190-441-53-01	2,000.00	465.69	1,534.31	23.28%
TRAINING	101-4190-441-58-05	2,800.00	2,302.42	497.58	82.23%
PRINTING & OFFICE SUPPLIES	101-4190-441-61-01	2,500.00	1,488.96	1,011.04	59.56%
VICTIM NOTIFICATION	101-4190-441-61-25	2,000.00	-	2,000.00	0.00%
VICTIM SERVICES	101-4190-441-61-26	2,500.00	-	2,500.00	0.00%
VEHICLE OPERATION & MAINTENANCE	101-4190-441-65-01	2,800.00	-	2,800.00	0.00%
		93,593.00	80,925.27	12,667.73	86.47%

UNION COUNTY SC
BUDGET TO ACTUAL VARIANCE

		2022-2023	PERIOD 13		%-AGE OF
		BUDGET	FY 2023	VARIANCE	BUDGET
			ACTUAL		
STADIUM					
SALARIES	101-5110-451-11-50	15,696.00	15,676.03	19.97	99.87%
INSURANCE	101-5110-451-44-01	3,790.00	3,822.49	(32.49)	100.86%
SOCIAL SECURITY	101-5110-451-44-02	1,201.00	1,075.30	125.70	89.53%
RETIREMENT	101-5110-451-44-04	2,757.00	2,752.71	4.29	99.84%
WORKERS COMPENSATION	101-5110-451-44-06	531.00	529.97	1.03	99.81%
UTILITIES	101-5110-451-40-01	39,000.00	27,534.74	11,465.26	70.60%
CLOTHING & UNIFORMS	101-5110-451-50-01	400.00	-	400.00	0.00%
MEMBERSHIPS & SUBSCRIPTIONS	101-5110-451-50-25	325.00	325.00	-	100.00%
TRAINING	101-5110-451-58-05	1,000.00	1,000.00	-	100.00%
BUILDING & EQUIPMENT EXPENSE	101-5110-451-60-10	25,000.00	18,930.41	6,069.59	75.72%
		89,700.00	71,646.65	18,053.35	79.87%
RECYCLING					
SALARIES	101-6101-461-11-50	225,503.00	208,694.40	16,808.60	92.55%
INSURANCE	101-6101-461-44-01	16,329.00	16,367.46	(38.46)	100.24%
SOCIAL SECURITY	101-6101-461-44-02	17,251.00	15,717.49	1,533.51	91.11%
RETIREMENT	101-6101-461-44-04	39,628.00	36,658.53	2,969.47	92.51%
WORKERS COMPENSATION	101-6101-461-44-06	14,696.00	11,991.91	2,704.09	81.60%
CONTRACT SERVICES	101-6101-461-32-10	49,660.00	49,613.27	46.73	99.91%
UTILITIES	101-6101-461-40-01	18,800.00	18,135.49	664.51	96.47%
WASTE TIRE DISPOSAL	101-6101-461-47-10	25,950.00	25,886.53	63.47	99.76%
CLOTHING & UNIFORMS	101-6101-461-50-01	840.00	839.97	0.03	100.00%
TRAINING	101-6101-461-58-05	500.00	486.60	13.40	97.32%
MAINTENANCE & UPKEEP	101-6101-461-60-30	7,250.00	7,234.46	15.54	99.79%
E-WASTE DISPOSAL	101-6101-461-60-45	-	-	-	NDIV/01
PRINTING & OFFICE SUPPLIES	101-6101-461-61-01	1,500.00	1,484.19	15.81	98.95%
SAFETY SUPPLIES	101-6101-461-61-08	2,780.00	2,779.35	0.65	99.98%
RECYCLING EQUIPMENT	101-6101-461-66-15	13,000.00	12,899.00	101.00	99.22%
HWY 18 TEMP FACILITY COSTS	101-6101-461-66-23	4,720.00	4,386.62	333.38	92.94%
		438,407.00	413,175.27	25,231.73	94.24%
AIRPORT					
SALARIES	101-7101-419-11-50	65,602.00	65,853.12	(251.12)	100.38%
INSURANCE	101-7101-419-44-01	15,289.00	15,276.74	12.26	99.92%
SOCIAL SECURITY	101-7101-419-44-02	5,019.00	4,470.63	548.37	89.07%
RETIREMENT	101-7101-419-44-04	11,520.00	11,563.75	(43.75)	100.38%
WORKERS COMPENSATION	101-7101-419-44-06	2,218.00	2,221.96	(3.96)	100.18%
MAINTENANCE CONTRACTS	101-7101-419-47-01	3,800.00	3,197.70	602.30	84.15%
MEMBERSHIPS & SUBSCRIPTIONS	101-7101-419-50-25	600.00	600.00	-	100.00%
TRAINING	101-7101-419-58-05	4,200.00	3,654.14	545.86	87.00%
BUILDING & EQUIPMENT EXPENSE	101-7101-419-60-10	7,500.00	7,362.26	137.74	98.16%
CAPITAL IMP & MATCHING FUNDS	101-7101-419-66-02	60,000.00	37,735.63	22,264.37	62.89%
		175,748.00	151,935.93	23,812.07	86.45%
TIMKEN SPORTS COMPLEX/REC DEPT					
SALARIES	101-8101-451-11-50	175,041.00	187,930.31	(12,889.31)	107.36%
SALARIES - SUMMER MAINTENANCE WKR	101-8101-451-11-53	25,000.00	495.60	24,504.40	1.98%
SALARIES - CONCESSIONS, GATE, TICKETS	101-8101-451-11-54	28,686.00	37,115.38	(8,429.38)	129.38%
INSURANCE	101-8101-451-44-01	28,834.00	28,793.88	40.12	99.86%
SOCIAL SECURITY	101-8101-451-44-02	17,498.00	15,458.46	2,039.54	88.34%
RETIREMENT	101-8101-451-44-04	30,738.00	31,376.06	(638.06)	102.08%
WORKERS COMPENSATION	101-8101-451-44-06	9,355.00	8,541.79	813.21	91.31%
UTILITIES	101-8101-451-40-01	148,900.00	135,180.19	13,719.81	90.79%
CLOTHING & UNIFORMS	101-8101-451-50-10	2,850.00	2,515.20	334.80	88.25%
ADVERTISING	101-8101-451-54-01	21,000.00	20,793.59	206.41	99.02%
FIELD MAINTENANCE	101-8101-451-54-55	46,000.00	42,306.72	3,693.28	91.97%
TRAINING	101-8101-451-58-05	2,000.00	1,527.58	472.42	76.38%
BUILDING EXPENSE	101-8101-451-60-01	11,000.00	10,397.35	602.65	94.52%
OPERATING EXPENSE	101-8101-451-60-15	115,385.00	95,513.62	19,871.38	82.78%
PRINTING & OFFICE SUPPLIES	101-8101-451-61-01	1,200.00	789.26	410.74	65.77%
SPECIALIZED DEPARTMENTAL SUPPLIES	101-8101-451-61-02	50,000.00	44,628.85	5,371.15	89.26%
CHEMICALS & FERTILIZERS	101-8101-451-61-10	25,000.00	21,100.87	3,899.13	84.40%
MACHINERY & EQUIPMENT REPAIR	101-8101-451-65-02	3,500.00	2,718.69	771.31	77.96%
CAPITAL IMPROVEMENTS	101-8101-451-66-02	15,000.00	27,788.55	(12,788.55)	185.26%
PARD MATCHING FUNDS	101-8101-451-66-22	6,000.00	3,562.50	2,437.50	59.38%
		762,987.00	718,544.45	44,442.55	94.18%

UNION COUNTY SC
BUDGET TO ACTUAL VARIANCE

		2022-2023	PERIOD 13		%-AGE OF
		BUDGET	FY 2023	VARIANCE	BUDGET
			ACTUAL		
EMERGENCY MEDICAL SERVICES					
SALARIES	101-9101-441-11-50	1,249,520.00	1,235,129.94	14,390.06	98.85%
SALARIES - PRN	101-9101-441-11-65	54,800.00	144,831.25	(90,031.25)	264.29%
INSURANCE	101-9101-441-44-01	195,205.00	190,037.53	5,167.47	97.35%
SOCIAL SECURITY	101-9101-441-44-02	99,781.00	101,210.96	(1,429.96)	101.43%
RETIREMENT	101-9101-441-44-04	229,039.00	242,577.41	(13,538.41)	105.91%
WORKERS COMPENSATION	101-9101-441-44-06	124,041.00	108,814.31	15,226.69	87.72%
UTILITIES	101-9101-441-40-01	26,894.00	25,415.06	1,478.94	94.50%
MAINTENANCE CONTRACTS	101-9101-441-47-01	25,000.00	21,316.61	3,683.39	85.27%
PROFESSIONAL SERVICES	101-9101-441-47-02	90,000.00	87,917.63	2,082.37	97.69%
VACCINES	101-9101-441-47-15	3,000.00	321.26	2,678.74	10.71%
CLOTHING & UNIFORMS	101-9101-441-50-01	14,177.00	12,683.91	1,493.09	89.47%
SPECIAL PROGRAM (EMS WEEK)	101-9101-441-50-20	1,000.00	910.58	89.42	91.06%
MEMBERSHIPS & SUBSCRIPTIONS	101-9101-441-50-25	900.00	-	900.00	0.00%
COMMUNICATIONS	101-9101-441-53-01	12,368.00	10,836.80	1,531.20	87.62%
TRAINING & TRAVEL	101-9101-441-58-07	5,000.00	4,592.89	407.11	91.86%
DISPOSAL FEES	101-9101-441-60-50	3,648.00	2,624.38	1,023.62	71.94%
SPECIALIZED DEPARTMENTAL SUPPLIES	101-9101-441-61-02	1,000.00	752.30	247.70	75.23%
GENERAL SUPPLIES	101-9101-441-61-03	55,000.00	54,496.35	503.65	99.08%
POSTAGE & FREIGHT	101-9101-441-61-07	300.00	44.16	255.84	14.72%
MEDICATION	101-9101-441-61-20	28,315.00	28,280.78	34.22	99.88%
VEHICLE OPERATIONS & MAINTENANCE	101-9101-441-65-01	65,000.00	57,944.76	7,055.24	89.15%
RADIO SYSTEM REPAIR	101-9101-441-65-03	700.00	-	700.00	0.00%
CAPITAL EXPENDITURES	101-9101-441-66-01	-	-	-	#DIV/0!
LEASE PAYMENTS	101-9101-441-66-04	43,762.00	36,991.32	6,770.68	84.53%
IT SERVICES	101-9101-441-66-20	11,230.00	6,472.30	4,757.70	57.63%
LICENSE FEES	101-9101-441-66-50	775.00	125.00	650.00	16.13%
		2,340,455.00	2,374,327.49	(33,872.49)	101.45%
TOTAL EXPENDITURES					
		22,820,451.00	20,695,816.83	2,116,634.17	90.69%

UNION COUNTY SC
BUDGET TO ACTUAL VARIANCE

		2022-2023 BUDGET ORIGINAL	PERIOD 13 FY 2023 ACTUAL REVISED	VARIANCE	%-AGE OF BUDGET
BUDGET LINE ITEM TRANSFERS:					
SALARIES	101-1505-415-11-50	56,650.00	34,250.00	(22,400.00)	8/30/2022
PROFESSIONAL SERVICES	101-1505-415-47-02	5,918.00	28,318.00	22,400.00	8/30/2022
MARKETING	101-1103-411-67-02	23,000.00	20,000.00	(3,000.00)	1/23/2023
TRAINING & TRAVEL	101-1103-411-58-05	10,000.00	13,000.00	3,000.00	1/23/2023
SALARIES	101-1505-415-11-50	34,250.00	17,597.00	(16,653.00)	1/24/2023
INSURANCE	101-1505-415-44-01	12,632.00	61.00	(12,571.00)	1/24/2023
SOCIAL SECURITY	101-1505-415-44-02	4,334.00	1,317.00	(3,017.00)	1/24/2023
RETIREMENT	101-1505-415-44-04	9,948.00	3,090.00	(6,858.00)	1/24/2023
WORKERS COMPENSATION	101-1505-415-44-06	2,612.00	522.00	(2,090.00)	1/24/2023
PROFESSIONAL SERVICES	101-1505-415-47-02	28,318.00	74,007.00	45,689.00	1/24/2023
UNIFORMS	101-1505-415-50-01	500.00	-	(500.00)	1/24/2023
TRAINING	101-1505-415-58-05	4,000.00	-	(4,000.00)	1/24/2023
TRAINING	101-6101-461-58-05	3,500.00	500.00	(3,000.00)	3/27/2023
RECYCLING EQUIPMENT	101-6101-461-66-15	10,000.00	13,000.00	3,000.00	3/27/2023
TRAINING	101-2110-421-58-05	1,000.00	500.00	(500.00)	3/28/2023
CLOTHING & UNIFORMS	101-2110-421-50-01	800.00	1,300.00	500.00	3/28/2023
PROFESSIONAL SERVICES	101-2320-423-47-02	64,235.00	48,623.00	(15,612.00)	4/10/2023
DIETING PRISONERS	101-2320-423-63-01	140,000.00	155,632.00	15,632.00	4/10/2023
CAPITAL EXPENDITURES	101-1990-419-66-01	837,733.00	780,733.00	(57,000.00)	4/12/2023
TRANSFER OUT	101-1990-599-99-99	-	57,000.00	57,000.00	4/12/2023
PRINTING & OFFICE SUPPLIES	101-1511-415-61-01	1,000.00	600.00	(400.00)	4/17/2023
TRAINING	101-1511-415-58-05	1,800.00	2,200.00	400.00	4/17/2023
CLOTHING & UNIFORMS	101-6101-461-50-01	3,500.00	840.00	(2,660.00)	4/20/2023
CONTRACT SERVICES	101-6101-461-32-10	43,000.00	45,660.00	2,660.00	4/20/2023
OPERATIONAL CONTINGENCY FUND	101-1105-411-75-02	3,000.00	2,500.00	(500.00)	5/2/2023
PRINTING & OFFICE SUPPLIES	101-1105-411-61-01	1,000.00	1,500.00	500.00	5/2/2023
FIELD MAINTENANCE	101-8101-451-54-55	50,000.00	46,000.00	(4,000.00)	5/8/2023
TRAINING	101-8101-451-58-05	4,000.00	2,000.00	(2,000.00)	5/8/2023
OPERATING EXPENSE	101-8101-451-60-15	70,000.00	76,000.00	6,000.00	5/8/2023
SUBSISTENCE CARE	101-2320-423-63-03	40,120.00	26,706.00	(13,414.00)	5/10/2023
DIETING PRISONERS	101-2320-423-63-01	155,632.00	169,046.00	13,414.00	5/10/2023
OTHER MISCELLANEOUS	101-4150-441-75-02	10,000.00	8,500.00	(1,500.00)	5/16/2023
SPECIALIZED DEPARTMENTAL SUPPLIES	101-4150-441-61-02	4,800.00	6,300.00	1,500.00	5/16/2023
OPERATIONAL CONTINGENCY FUND	101-1104-411-75-02	1,000.00	500.00	(500.00)	5/18/2023
TRAINING & TRAVEL	101-1104-411-58-06	3,000.00	3,500.00	500.00	5/18/2023
PROFESSIONAL SERVICES	101-2901-429-47-02	25,000.00	2,750.00	(22,250.00)	5/22/2023
MAINTENANCE CONTRACTS	101-2901-429-47-01	111,583.00	133,833.00	22,250.00	5/22/2023
OPERATING EXPENSE	101-8101-451-60-15	76,000.00	96,000.00	20,000.00	5/22/2023
This is an addition based on additional revenue due to increased prices					
FOOD ALLOWANCE FOR ANIMALS	101-2110-421-63-03	5,000.00	4,500.00	(500.00)	5/31/2023
SPECIALIZED DEPARTMENTAL SUPPLIES	101-2110-421-61-02	30,959.00	31,459.00	500.00	5/31/2023
OPERATING EXPENSE	101-8101-451-60-15	96,000.00	111,000.00	15,000.00	6/1/2023
This is an addition based on additional revenue due to increased prices					
MEMBERSHIPS & SUBSCRIPTIONS	101-1201-412-50-25	1,000.00	789.00	(211.00)	6/3/2023
JURY PAY	101-1201-412-54-10	15,000.00	14,395.00	(605.00)	6/3/2023
APPEALS	101-1201-412-54-15	1,500.00	301.00	(1,199.00)	6/3/2023
JAIL OFFICE SUPPLIES	101-1201-412-61-02	1,500.00	1,155.00	(345.00)	6/3/2023
TRAINING & TRAVEL	101-1201-412-58-06	6,200.00	8,560.00	2,360.00	6/3/2023
TRAINING	101-4120-441-58-05	3,437.00	2,437.00	(1,000.00)	6/5/2023
PRINTING & OFFICE SUPPLIES	101-4120-441-61-01	990.00	1,590.00	1,000.00	6/5/2023
FUEL COSTS	101-1990-419-65-11	425,000.00	385,000.00	(40,000.00)	6/5/2023
PROFESSIONAL SERVICES	101-1990-419-47-02	350,000.00	390,000.00	40,000.00	6/5/2023
EVIDENCE CUSTODIAN SUPPLIES	101-2101-421-61-12	4,000.00	3,900.00	(100.00)	6/8/2023
PRINTING & OFFICE SUPPLIES	101-2101-421-61-01	12,000.00	12,100.00	100.00	6/8/2023
NARCOTICS SUPPLIES	101-2101-421-61-13	15,000.00	13,600.00	(1,400.00)	6/8/2023
STATE 800 RADIO SERVICES	101-2101-421-66-11	20,500.00	19,000.00	(1,500.00)	6/8/2023
MOBILE ROUTER RENEWAL FEES	101-2101-421-66-51	5,500.00	8,400.00	2,900.00	6/8/2023
CAT LIVING PENS	101-2110-421-66-13	1,000.00	-	(1,000.00)	6/20/2023
SPECIALIZED DEPARTMENTAL SUPPLIES	101-2110-421-61-02	31,459.00	32,459.00	1,000.00	6/20/2023
OPERATING EXPENSE	101-8101-451-60-15	111,000.00	115,385.00	4,385.00	6/20/2023
This is an addition based on additional revenue due to increased prices					
MAINTENANCE & UPKEEP	101-6101-461-60-30	8,000.00	7,250.00	(750.00)	6/27/2023
UTILITIES	101-6101-461-40-01	20,000.00	18,800.00	(1,200.00)	6/27/2023
WASTE TIRE DISPOSAL	101-6101-461-47-10	24,000.00	25,950.00	1,950.00	6/27/2023
CAPITAL EXPENDITURES	101-1103-411-66-01	10,000.00	9,400.00	(600.00)	6/27/2023
TRAINING & TRAVEL	101-1103-411-58-05	13,000.00	13,600.00	600.00	6/27/2023
HWY 18 TEMP FACILITY COSTS	101-6101-461-66-23	5,000.00	4,720.00	(280.00)	6/27/2023
SAFETY SUPPLIES	101-6101-461-61-08	2,500.00	2,780.00	280.00	6/27/2023

UNION COUNTY SC
BUDGET TO ACTUAL VARIANCE

		2022-2023	PERIOD 13		%-AGE OF
		BUDGET	FY 2023	VARIANCE	BUDGET
			ACTUAL		
CLOTHING & UNIFORMS	101-2320-423-50-01	14,000.00	11,735.00	(2,265.00)	7/17/2023
COMMUNICATIONS	101-2320-423-53-01	5,000.00	2,030.00	(2,970.00)	7/17/2023
TRAINING	101-2320-423-58-05	5,000.00	4,311.00	(689.00)	7/17/2023
OPERATING EXPENSE	101-2320-423-60-15	21,120.00	20,320.00	(800.00)	7/17/2023
PRINTING & OFFICE SUPPLIES	101-2320-423-61-01	4,500.00	9,678.00	(822.00)	7/17/2023
SPECIALIZED DEPARTMENTAL SUPPLIES	101-2320-423-61-02	26,700.00	26,065.00	(635.00)	7/17/2023
CHEMICALS	101-2320-423-61-10	10,500.00	8,379.00	(2,121.00)	7/17/2023
DIETING PRISONERS	101-2320-423-63-01	169,046.00	179,348.00	10,302.00	7/17/2023
PRINTING & OFFICE SUPPLIES	101-2101-421-61-01	12,100.00	11,900.00	(200.00)	7/24/2023
TRAINING	101-2101-421-58-05	11,000.00	11,200.00	200.00	7/24/2023